



OMNIA Get to Know You Flyer and Company Wide Communication Distribution

- Division Presidents
- Division Sales Manager
- Region Sales Managers
- Branch Operations Manager
- Local Account Managers
- Branch eMails for release to Branch Administrative Staff
 - What / Who is OMNIA
 - Benefits for Orkin and government agencies
 - Contract Specifics

TEAMS Meetings with Division / Region Managers “Intro to OMNIA”

- OMNIA Agreement Info
- Pricing
- Benefits for Orkin
- Benefits for government agencies
- Sales Materials for distribution to Account Manager

TEAMS Meetings with Region Manager / Local Account Managers

- Sales Materials, Logos
- How to Position OMNIA contract
- What public sector agencies to target
- SAMPLE Proposal



OMNIA Partners is the largest and most trusted cooperative purchasing organization for public sector procurement. We have brought together the nation's two leading cooperative purchasing organizations – National IPA and U.S. Communities – under one roof to form OMNIA Partners, Public Sector. The collective buying power of these unified purchasing cooperatives delivers superior value and savings for public agencies nationwide.

Portfolio

OMNIA Partners has the most robust portfolio of quality cooperative contracts in the cooperative space. Our contract portfolio has everything your organization needs to run efficiently and effectively.

People

OMNIA Partners has the most experienced team in public procurement, cooperative purchasing and contract management. With more than 150 employees and over 20 years as a dedicated cooperative purchasing organization, you can trust that our cooperative contract portfolio is backed by the resources, expertise and experience that would exceed the standards set by the most tenured public procurement professionals. OMNIA Partners is also a founding member of National Cooperative Procurement Partners.

Process

Our cooperative contracts are competitively solicited and publicly awarded by a government entity serving as the lead agency. Awards are made utilizing this best practice ensuring maximum value with complete transparency of the process.

Participation

OMNIA Partners saves you time and money. Participating in the cooperative buying power of more than 60,000 entities helps you do more with less by reducing product and administrative costs. We are the largest and fastest-growing organization in public procurement, creating maximum purchasing power and resources for our participants.

OMNIA Partners, Public Sector participation has almost tripled over the past six years. We continue to put the people, processes and solutions in place to support the needs of public agencies and educational institutions nationwide.

OMNIA Partners saves you time and money. Participating in the cooperative buying power of more than 60,000 entities helps you do more with less by reducing product and administrative costs. We are the largest and fastest-growing organization in public procurement, creating maximum purchasing power and resources for our participants.

OMNIA Partners, Public Sector participation has almost tripled over the past six years. We continue to put the people, processes and solutions in place to support the needs of public agencies and educational institutions nationwide.

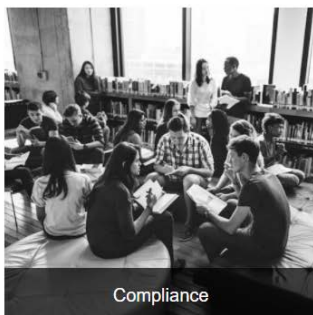



Orkin, LLC

2020 Valid System for Award Management Registration



A NEW WAY TO SIGN IN - If you already have a SAM account, use your **SAM email** for login.gov.

[Log In](#)

[Login.gov FAQs](#)

[HOME](#) [SEARCH RECORDS](#) [DATA ACCESS](#) [CHECK STATUS](#) [ABOUT](#) [HELP](#)



ALERT: SAM.gov will be down for scheduled maintenance Saturday, 11/09/2019, from 8:00 AM to 3:00 PM

Entity Dashboard

- › [Entity Overview](#)
- › [Entity Registration](#)
 - › [Core Data](#)
 - › [Assertions](#)
 - › [Reps & Certs](#)
 - › [POCs](#)
- › [Exclusions](#)
 - › [Active Exclusions](#)
 - › [Inactive Exclusions](#)
 - › [Excluded Family Members](#)

[RETURN TO SEARCH](#)

Orkin, LLC
DUNS: 002509420 CAGE Code: 1FNT3
Status: Active
Expiration Date: 10/30/2020
Purpose of Registration: All Awards
2170 Piedmont Rd NE
Atlanta, GA, 30324-4135 ,
UNITED STATES

Entity Overview

Entity Registration Summary

Name: Orkin, LLC
Doing Business As: Orkin Pest Control
Business Type: Business or Organization
Last Updated By: Deborah Toth
Registration Status: Active
Activation Date: 10/31/2019
Expiration Date: 10/30/2020

Exclusion Summary

Active Exclusion Records? No



INSPECTION REPORT

Business Name: [REDACTED]

Service Address: 2360 E. Pershing Blvd Cheyenne, WY 82001

Account Manager: [REDACTED]

Date: October 30, 2018

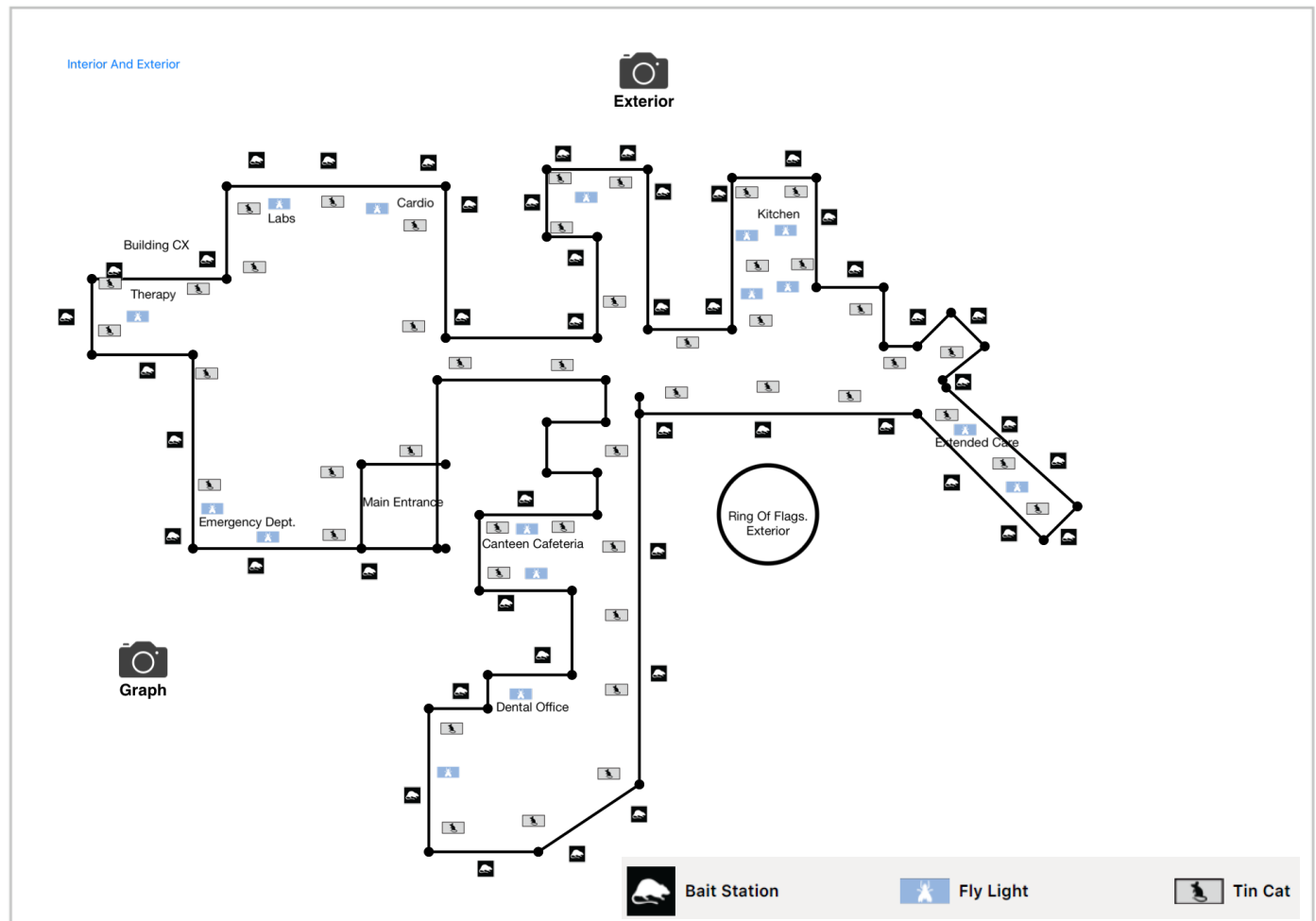

Icon indicates general area and is not precise.
Insect evidence and conditions may be widespread.

Bait Station Count: 46

Tin Cat Count: 45

Pest Monitor Count: 0

Fly Light Count: 16

Door Sweep Count: 0

Air Curtain Count: 0

Restroom Care Count: 0

Actizyme Dispenser Count: 0

Actizyme Odor Control Count: 0

Pheromone Trap Count: 0

Glue Trap Count: 0

A decorative pattern of light gray hexagons of varying shades, arranged in a staggered grid, spanning the top of the slide.

ORKIN'S CUSTOMER RELATIONS NETWORK

ORKIN

InSiteTM

WHAT IS ORKIN INSITE™?



- Orkin InSite is a comprehensive customer portal that provides service data and analysis of your pest control program.
- The customizable dashboard provides a high-level overview of your pest control program, including current pest levels, pest pressure trends, past service reports and your next scheduled service visit(s).



WHAT WE'LL COVER

- Account Insights
- Customer Alerts
- Digital Logbook
- Reporting
- Login and Account Registration





ACCOUNT INSIGHTS



COMPREHENSIVE DOCUMENTATION

- Insight on the health of your pest management program is available 24/7 on <http://www.orkininsite.com>.
- Easily navigate through the system to see one location or multiple.
- The dashboard shows current pest levels and pest trends over time.



CUSTOMIZED REPORTING

- One-time reporting setup means you only have to configure your preferences once, with the flexibility to change settings at any time. Plus, data is delivered straight to your inbox in the format you select.

The screenshot displays the 'My Reports' configuration page in the ORKIN system. The top navigation bar includes 'DASHBOARD', 'MY REPORTS', and 'CONFIGURATION'. The main heading is 'My Reports'. Below this, there are two tabs: 'Run Report' (active) and 'Report Definitions'. The 'Run Report' tab contains a 'Report Basics' section with the following fields:

- Customer ***: A search bar containing 'Demo Client, Inc.' with a magnifying glass icon.
- Report ***: A dropdown menu showing 'Public' and 'Pest Finding Analysis'.
- Date Range**: A section with 'Year-to-date' selected, and date pickers for '01/01/2018' and 'Until 03/06/2018'.
- Location**: A row of buttons: 'All' (selected), 'Single', 'Group', and 'Hierarchy'.

At the bottom right of the form is a red 'Run Report' button. A 'Next Step' link is visible in the bottom right corner of the page.



CONNECTIVITY

- Address account issues, questions or needs via the portal by contacting members of your internal or Orkin team at the click of a button.

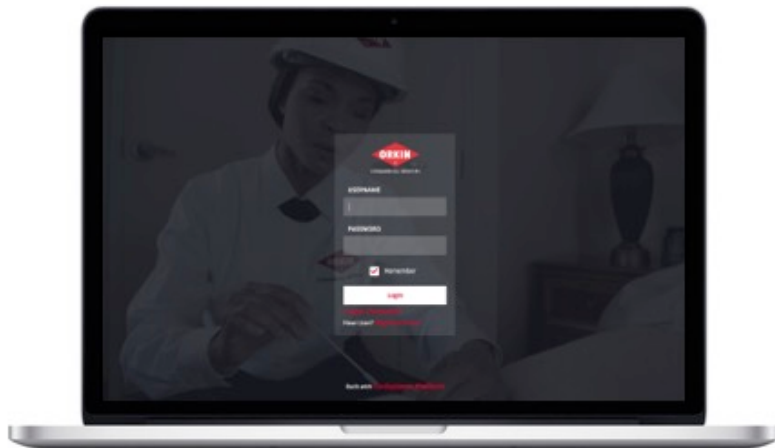



CUSTOMER ALERTS



CUSTOMER ALERTS

- Orkin InSite allows you to set preferences and receive pest activity and program improvement alerts via email, text or phone call.
- Escalation alerts can also be set to specific threshold levels, so you control when you are notified about pest activity.

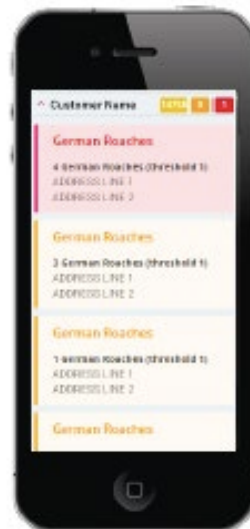

CUSTOMER ALERTS BY LOCATION

- If managing multiple locations, InSite specifies which location the alert is coming from.

German Roaches Level 3 Alert

Service: 08 May 2017 Service Ticket #: 157554356

Location: Customer Name
ADDRESS LINE 1
ADDRESS LINE 2

Zone: 05 FOOD PREPARATION

Pest Type: Cockroaches - 4 found (threshold 1)

Observation: Activity - Dead

Recommendation: Treated Per Scope

Notes To Customer: Interior traps and exterior bait stations serviced. Exterior perimeter treated with residual insecticide and granular insect bait

Custom Observation Note: Activity - Dead: No Activity

Custom Recommendation Note: Treated Per Scope

Dismiss Notification

6 Stations

contacts

Map showing location: Préville

Legend: Fire Ants (red line), Spiders (green line)



CUSTOMER RESPONSIBILITY ALERTS

- Through InSite, you can receive “customer responsibility alerts” that include recommended actions to perform before your next service visit.

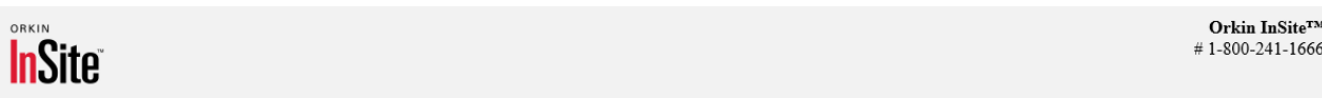

Alert for

Pest Alert for

No Pest Alerts for this service...

Customer Responsibility Alert for

Service Ticket #: [182704764](#)

Occurrence Date:

Location:

Address:

Definition:

Level	Zone	Station	Observations	Recommendations	Previously reported on
Level 2	10 FLOOR DRAINS (REQUIRED)	0001 next to main entrance door frame	Drain Issue	Check Drain Lines	03/17/2019 9:28AM



PEST FINDINGS ALERT

- Through InSite, you can receive “pest finding alerts” that include recommended actions to perform before your next service visit.

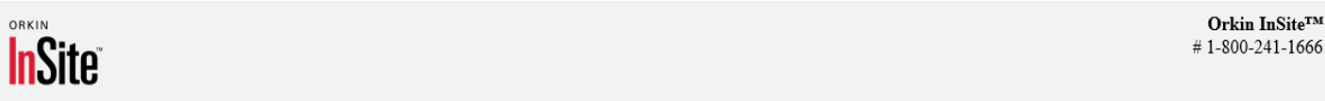

Alert for

Pest Alert for

Service Ticket #: [183414769](#)

Occurrence Date:

Location:

Address:

Definition:

Pest Type: Rodent

<i>Level/Intensity</i>	<i>Zone</i>	<i>Station</i>	<i>Pest</i>	<i>QTY (Threshold)</i>	<i>Observations</i>	<i>Recommendations</i>	<i>Previously reported on</i>
Level 1	02 EXTERIOR	0002	Mice	0 (0)	Bait Eaten - Rodents	Replaced Bait	





DIGITAL LOGBOOK



DETAILED DOCUMENTATION

- Orkin's digital logbook gives a detailed documentation report of your pest control program. This online view will help keep track of important pest trend data and information. In this report you'll find:
 - Client Information
 - Service Details
 - Threshold Limits
 - Devices and Floor Plans
 - Approved Products
 - Training Records



CLIENT INFORMATION

- View details about the type of business, contact information and external auditing agencies, as well as any special requirements about safety, attire, etc.

Client Information	Service Details	Threshold Limits	Devices and Floorplan	Report and Logs	Approved Products	Licenses, Certifications and Insurance	Manage Logbook
General Client Information							
Customer				Prepared By			
BOSS Account Number				Local / National			
Contact Information							
Billing Address			Service Location Address				
Site Contacts							
Primary On Site Contact				Secondary On Site Contact			
Contract Signatory Name				Other Persons Authorized to Sign Service Guides			
Orkin Contact Information							
Branch Contact				Quality Assurance Contact			



SERVICE DETAILS

- View the different services currently being performed by your Orkin technician.

Client Information	Service Details	Threshold Limits	Devices and Floorplan	Report and Logs	Approved Products	Licenses, Certifications and Insurance	Manage Logbook
--------------------	------------------------	------------------	-----------------------	-----------------	-------------------	--	----------------

Service Details

Program Name	JDE Program Id	Type	Start Date	Renewal Month	Frequency	Is Child
PC Standard - Monthly		PC	05/05/2008	May	Monthly	

Pest Coverage

Client Standards and Guidelines

Service and Security Arrangements

Service Day and Time

Workcenter Location on Site

Special Notes

Devices Installed at the Client Service Location
(Outdoor Bait Stations, Rodent and Insect Traps, Fly Traps, Odor Control Units, etc.)

Exterior Devices

Interior Devices

Additional Services Provided
(Exterior Application, Quality Assurance, etc.)

# of Manager Inspections / Year	0	# of QA Inspections / Year	1
---------------------------------	---	----------------------------	---

Additional Information
(Information regarding client requests, who audits the facility, etc.)



THRESHOLD LIMITS

- View the pests reported at your location(s) and their respective preventative measures and corrective actions.

Client Information	Service Details	Threshold Limits	Devices and Floorplan	Report and Logs	Approved Products	Licenses, Certifications and Insurance	Manage Logbook
Insects and Arthropods							
Pest	Threshold	Preventative Measures	Corrective Actions				
Cockroaches		<ul style="list-style-type: none">- Maintain a monitoring system in areas of possible infestation- Maintain high housekeeping standards and good manufacturing processes	<ul style="list-style-type: none">- Locate Point of Infestation- Initiate corrective actions to eliminate pest infestation (cleaning, insecticidal, application, fumigation, etc.)				
Stored Products Pests (Moths, Beetles, Weevils, etc.)		<ul style="list-style-type: none">- Maintain a monitoring system in areas of possible infestation- Maintain high housekeeping standards and good manufacturing processes	<ul style="list-style-type: none">- Locate Point of Infestation- Initiate corrective actions to eliminate pest infestation (cleaning, insecticidal, application, fumigation, etc.)				
Crawling Insects (Ants, Silverfish, Earwigs, etc)		<ul style="list-style-type: none">- Maintain a monitoring system in areas of possible infestation- Seal points of entry throughout the facility	<ul style="list-style-type: none">- Locate points of entry- Apply insecticide per scope of service to areas of infestation- Offer structural recommendations to eliminate infestation				
(Inside) Flying Insects		<ul style="list-style-type: none">- Control exterior flying insect entry (plastic and air curtains, screens)- Install proper number of flytraps to minimize insect entry	<ul style="list-style-type: none">- Locate points of entry and correct if possible- Test efficiency of flytrap program				
Birds							
Pest	Threshold	Preventative Measures	Corrective Actions				
Pigeons, Starlings, Sparrows, etc.		<ul style="list-style-type: none">- Ensure that the structure does not provide nesting or loafing- Initiate bird population dispersal program (structural modifications, feeding stations, deterrent products, etc.)	<ul style="list-style-type: none">- Remove Active Nesting Sites- Clean and disinfect areas of bird dropping accumulations- Perform the required corrective actions to eliminate bird population				



DEVICE AND FLOOR PLAN

- View a facility schematic showing the placement of pest control devices.

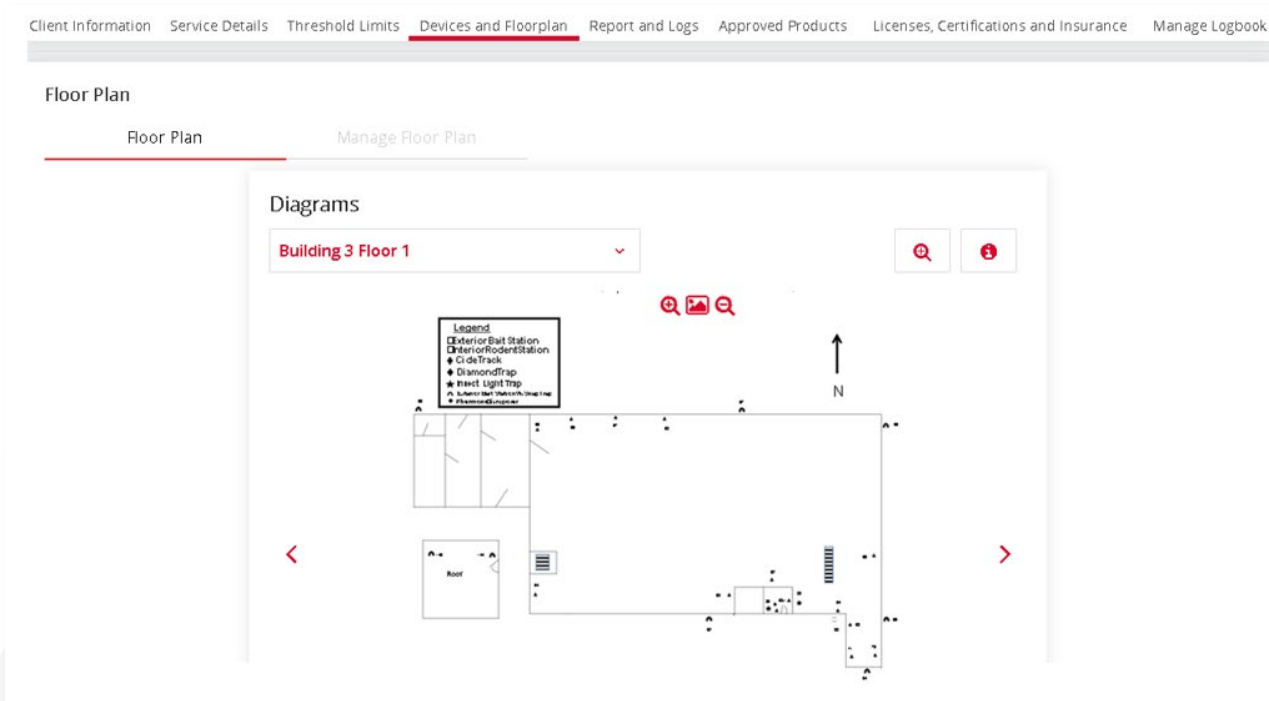

REPORTS AND LOG

- View the type of service, service history and service ticket reports.

Client Information

Service Details

Threshold Limits

Devices and Floorplan

Report and Logs

Approved Products

Licenses, Certifications and Insurance

Manage Logbook

Service Reports

Q

Search by Service Ticket #

Custom date range

MM/DD/YYYY

to

MM/DD/YYYY

Search

Reset

SERVICE HISTORY (7)	SERVICE TYPE	DATE	CASE ID#	SERVICE TICKET #
<div>✓</div> Recurring Service	Recurring Service	03/01/2018		#166671886
<div>✓</div> Recurring Service	Recurring Service	01/02/2018		#165915915 <div>📄</div> <div>📄</div>
<div>✓</div> Recurring Service	Recurring Service	12/05/2017		#164621778 <div>📄</div> <div>📄</div>
<div>✓</div> Recurring Service	Recurring Service	11/07/2017		#163962052 <div>📄</div> <div>📄</div>
<div>✓</div> Recurring Service	Recurring Service	10/11/2017		#163962051 <div>📄</div> <div>📄</div>
<div>✓</div> Recurring Service	Recurring Service	09/05/2017		#163962050 <div>📄</div> <div>📄</div>
<div>✓</div> First Month	First Month	08/01/2017		#163962049 <div>📄</div> <div>📄</div>



APPROVED PRODUCTS

- View the list of approved pesticides, pesticide application data and respective SDS and labels.

[Client Information](#) [Service Details](#) [Threshold Limits](#) [Devices and Floorplan](#) [Report and Logs](#) [Approved Products](#) [Licenses, Certifications and Insurance](#) [Manage Logbook](#)

☐ Add selected products to Corporate Approved List

Select Product

Search

PRODUCT NAME	MANUFACTURER	DOCUMENTS		
Rabbit Scram Professional	EPIC	SDS	Label	+
PT Alpine Flea & Bed Bug Pressurized	BASF	SDS	Label	+
Cidettrak IMM	Treco	SDS	Label	+
Rabbit Scram Pro Supplemental 2	EPIC	Label	+	
Deer Scram Professional	EPIC	SDS	Label	+
Round Up Pro Max Non-Crop Supplemental	Monsanto	Label	+	

1 to 50 of 362 records

1 2 3 4 5 ... >

Products Added To Location Approved List

Currently, there are no products added to the approved list



LICENSES, CERTIFICATIONS & INSURANCE

- View detailed training records of the technicians servicing your location(s), along with copies of various licenses and the insurance certificate.

[Client Information](#) [Service Details](#) [Threshold Limits](#) [Devices and Floorplan](#) [Report and Logs](#) [Approved Products](#) [Licenses, Certifications and Insurance](#) [Manage Logbook](#)

Branch Contacts

Branch Manager	Unknown
Service Manager	Unknown
Pest Specialist (Assigned Technician)	Unknown

Licenses and Certificates

Assigned Servicing Technicians (Current)



There are none currently technicians assigned

Other Servicing Technicians (Last 12 Months)

EMPLOYEE NAME	ROLE	DOCUMENT	TYPE	EXPIRATION DATE
National Accounts		N/A	N/A	
Richard Tolle		N/A	N/A	

2 records



MANAGE LOGBOOK

- Manage documents, client information, service details and threshold limits within your digital logbook.

The screenshot displays the 'Manage Logbook' section of a software interface. At the top, a horizontal navigation bar contains several tabs: 'Client Information', 'Service Details', 'Threshold Limits', 'Devices and Floorplan', 'Report and Logs', 'Approved Products', 'Licenses, Certifications and Insurance', and 'Manage Logbook' (which is highlighted with a red underline). Below the navigation bar, the 'Manage Logbook' title is followed by a warning icon and the text 'Any unsaved changes will be lost on leaving Manage Logbook section.' To the right of this is a red button labeled 'Generate New Logbook PDF File'. Below the warning, there are four sub-tabs: 'Digital Logbook Documents' (active), 'Edit Client Information', 'Edit Service Details', and 'Edit Theshold Limits'. Under the 'Digital Logbook Documents' tab, the heading 'Digital Logbooks List' is followed by a large dashed rectangular box. Inside this box is a placeholder icon consisting of a grid of horizontal lines, and below it, the text 'There are currently no generated Digital Logbooks'.





REPORTING



RUN A REPORT



- To view reports, click the “View All Reports” option. From there, you can choose the type of report needed.
- Select the desired date range and location and click “Run Report.”
- You can choose all locations for a given report (all), one location (single) or a group of locations within a specific region or area (hierarchy).

A screenshot of a web application window titled "Run a Report" with a close button (X) in the top right corner. The window has two tabs: "Report Basics" (active, highlighted in red) and "Additional Filters". Under "Report Basics", there are several sections: "Customer *" with a search input field; "Report *" with a dropdown menu showing "Public" in green and "InSite Service Ticket Report" in red, with a note "Updated From CWR Service Ticket Report" below it; "Language" with a dropdown menu showing "English"; "Date Range" with a dropdown menu showing "- Select a Date Range -", and two date pickers for "04/30/2019" and "Until 05/30/2019"; and "Location" with three buttons: "All" (highlighted in red), "Single", and "Hierarchy". At the bottom right, there is a red "Run Report" button and a "Next Step" link.

TYPES OF REPORTS



- Service Summary Report
- Service Detail Report by Workorder
- Pest Trend Report
- Total Pest Findings
- Orkin Pest Groups Trend by Location and Service Date
- Observations by Workorder
- Pest Findings by Workorder
- Sanitation & Structure Recommendations and Trends
- InSite Service Ticket Report
- Pest Activity for Multiple Locations
- Service Summary by Location
- Station Inventory Report by Location and Trap
- InSite Service Ticket Report With Zone Summary
- Pesticide Usage Log
- Pest Findings Analysis
- Observation Findings Analysis
- Corporate Pest Findings

SERVICE SUMMARY REPORT

- Overview of services performed by location over a specific time frame.

Service Summary Report

Service History (10)

		SERVICE TYPE	
✓	Fly Lights/Traps - Add On	Recurring Service	05/01/2017
✓	PC Standard	Recurring Service	05/01/2017
✓	PC Standard	Recurring Service	04/03/2017
✓	Fly Lights/Traps - Add On	Recurring Service	04/03/2017
✓	Fly Lights/Traps - Add On	Recurring Service	03/06/2017

[+ More](#)

Next Scheduled Service (0)

SERVICE TYPE

No records to show...



SERVICE DETAIL REPORT BY WORKORDER

- Includes all service details by workorder, including everything from inspection time to the quantity of pests captured.

Station Inspection Scan Timestamp	Zone Name	Trap Type	Station Name	Station Inspection Status	Station Inspection Status Reason	Observation	Action Plan	Pest	Pest Qty
4/30/2019 10:33:40 AM	73 CEILING	Rodent Traps	0004	Skipped	Station Blocked				
4/30/2019 10:33:40 AM	73 CEILING	Rodent Traps	0005	Skipped	Station Blocked				
4/30/2019 10:33:40 AM	73 CEILING	Rodent Traps	0002	Skipped	Station Blocked				
4/30/2019 10:33:40 AM	73 CEILING	Rodent Traps	0003	Skipped	Station Blocked				
4/30/2019 10:36:46 AM	66 OFFICES	Inspection	0001 Door Frame	Serviced		No Activity / Inspection Provided	No Activity Found - Inspected		
4/30/2019 10:37:31 AM	62 FOOD PREPARATION	Rodent Traps	0003 Under Breeding Flour	Serviced		No Activity / Inspection Provided	No Activity Found - Inspected		
4/30/2019 10:38:14 AM	58 STORAGE AREAS	Inspection	0004 Inside receiving door	Serviced		Debris Present	Clean Area		
4/30/2019 10:38:39 AM	58 STORAGE AREAS	Inspection	0001 Inside Dry storage to left of door	Serviced		Moisture Accumulation	Remove Spillage		
4/30/2019 10:39:17 AM	71 MECHANICAL ROOMS	Inspection	0003 Water Heater	Serviced		Moisture Accumulation	Remove Spillage		
						Debris Present	Clean Area		
4/30/2019 10:40:07 AM	43 SERVICE COUNTERS	Inspection	0001 Left of Right register	Serviced		No Activity / Inspection Provided	No Activity Found - Inspected		
4/30/2019 10:40:43 AM	62 FOOD PREPARATION	Inspection	0001 Exhaust hood control box	Serviced		Debris Present	Clean Area		
4/30/2019 10:40:49 AM	62 FOOD PREPARATION	Inspection	0004 Exhaust hood control box	Deleted	Station Removed				
4/30/2019 10:41:56 AM	72 DRIVE THRU	Inspection	0001 Right of window	Serviced		No Activity / Inspection Provided	No Activity Found - Inspected		
4/30/2019 10:42:21 AM	01 LOGBOOK	Inspection	0001 OFFICE	Serviced		Service Ticket / Invoice	Added Document		
4/30/2019 10:45:24 AM	77 RESTROOMS	Inspection	0002 MEN'S RESTROOM UNDER SINK	Serviced		No Activity / Inspection Provided	No Activity Found - Inspected		
4/30/2019 10:46:23 AM	77 RESTROOMS	Inspection	0003	Serviced		No Activity / Inspection Provided	No Activity Found - Inspected		
4/30/2019 10:46:23 AM	77 RESTROOMS	Inspection	0003	Added	Activity				
4/30/2019 10:46:36 AM	77 RESTROOMS	Inspection	0001 WOMEN'S RESTROOM UNDER SINK	Deleted	Station Removed				
4/30/2019 10:47:16 AM	81 DINNING ROOM	Inspection	0001 Inside trash bin door right of double doors	Serviced		Debris Present	Clean Area		
4/30/2019 10:50:01 AM	54 EXTERIOR	Inspection	0002 Exterior receiving door	Serviced		No Activity / Inspection Provided	No Activity Found - Inspected		
4/30/2019 10:50:20 AM	54 EXTERIOR	E. Rodent Bait Station	0002.1 Left side electrical panel for bait station	Serviced		No Activity / Inspection Provided	No Activity Found - Inspected		
4/30/2019 10:51:43 AM	54 EXTERIOR	Inspection	0005	Added	Activity				
4/30/2019 10:51:43 AM	54 EXTERIOR	Inspection	0005	Serviced		No Activity / Inspection Provided	No Activity Found - Inspected		
4/30/2019 10:52:27 AM	54 EXTERIOR	E. Rodent Bait Station	0003 Back of building	Skipped	Change Barcode				
4/30/2019 10:52:27 AM	54 EXTERIOR	E. Rodent Bait Station	0001 Dumpster area	Skipped	Change Barcode				
4/30/2019 10:52:27 AM	54 EXTERIOR	Inspection	0004 Dumpster area	Skipped	Change Barcode				



PEST TREND REPORT

- View activity trends for various pests by service date. This trend will appear on the Customer Dashboard. Trend will change based on location selected. Default trend will show all locations.

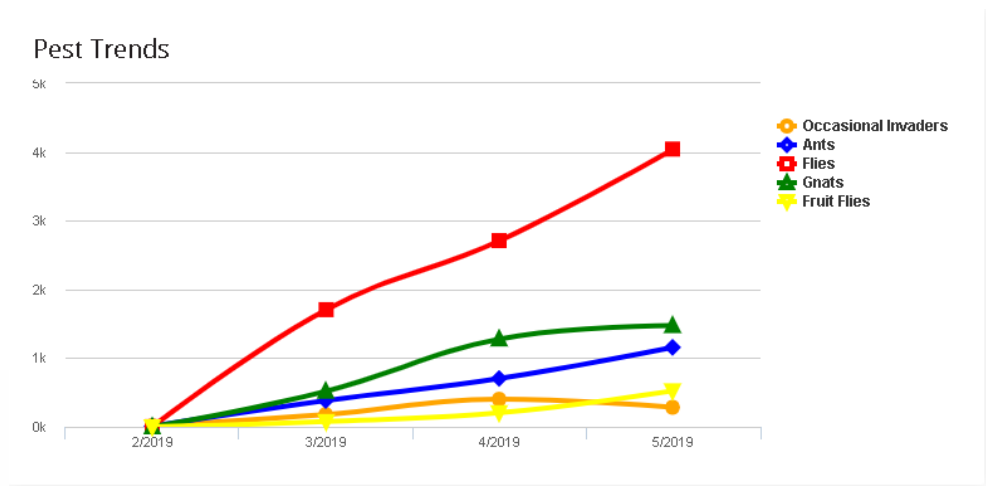

TOTAL PEST FINDINGS



- View current pest activity levels and pest trends over time for all locations. Changes quantity based on location selected.
- Using this trend analysis, you can work with your Orkin technician to adjust your program over time, based on the pest threats unique to your property.

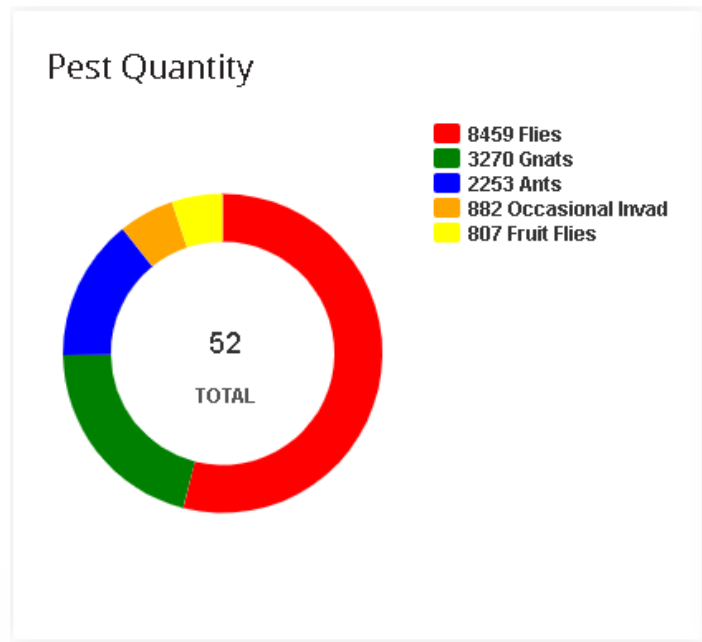

Orkin Pest Groups Trend by Location and Service Date

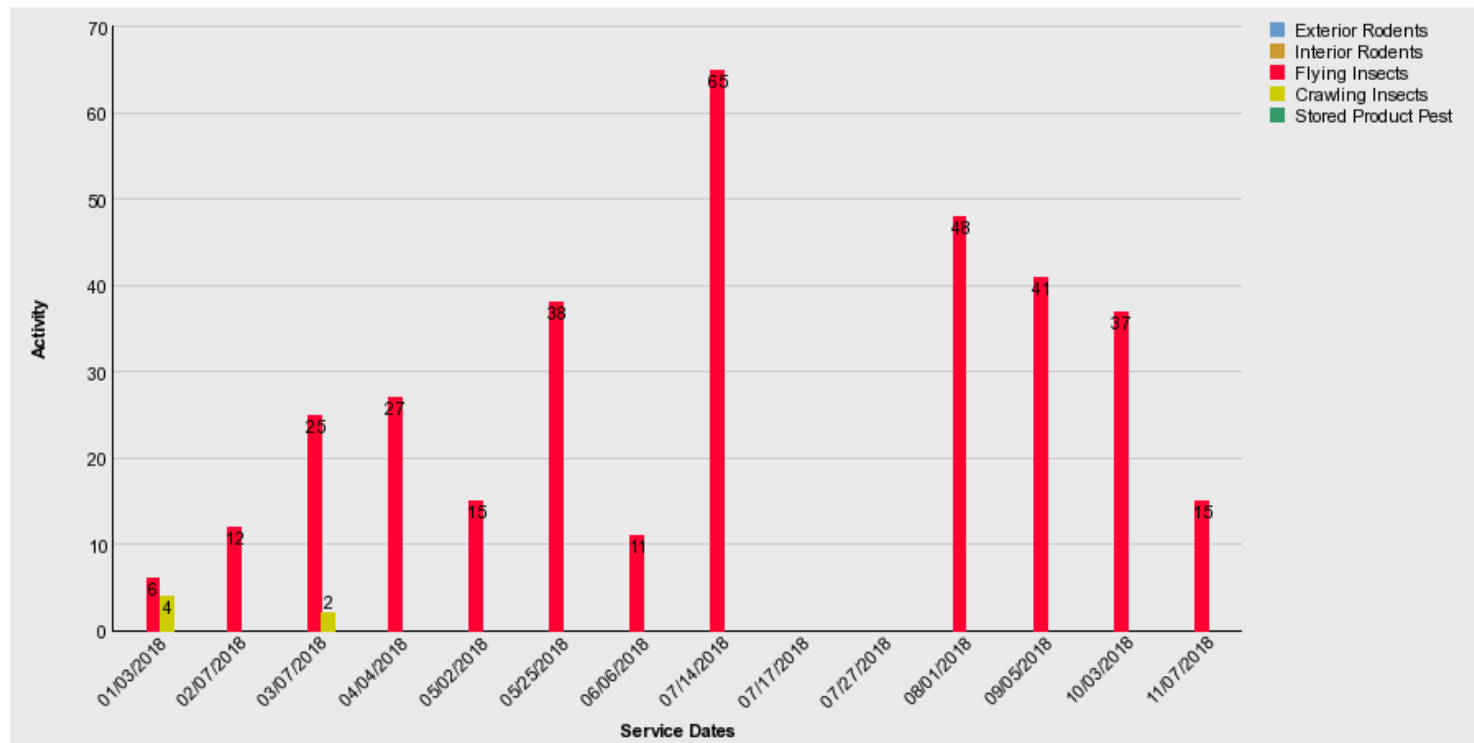

OBSERVATIONS BY WORKORDER

- View, by workorder, the lists of instances where an observation was recorded by the technician.

Inspection Timestamp	Zone Name	Station Name	Trap Type	Status	Reason	Observation	Action Plan
1/17/2018 9:23:08 AM	Protecta	0001	E. Rodent Bait Station	Serviced		No Activity	Cleaned
1/17/2018 9:24:15 AM	Protecta	0002	E. Rodent Bait Station	Serviced		No Activity	Cleaned
1/17/2018 9:24:40 AM	Pop Machine	0001	Inspection	Serviced		No Activity	Cleaned
1/17/2018 9:26:00 AM	Protecta	0004	Rodent Traps	Serviced		No Activity	Cleaned
1/17/2018 9:26:18 AM	Office	0001	Inspection	Serviced		No Activity	Cleaned
1/17/2018 9:26:54 AM	Tincats	0001	Rodent Traps	Serviced		No Activity	Cleaned
1/17/2018 9:26:58 AM	Ceiling	0001	Glue Board	Serviced		No Activity	Cleaned
1/17/2018 9:27:52 AM	Tincats	0002	Rodent Traps	Serviced		No Activity	Cleaned
1/17/2018 9:28:02 AM	Back Door	0001	Inspection	Serviced		No Activity	Cleaned
1/17/2018 9:28:04 AM	Ceiling	0002	Glue Board	Serviced		No Activity	Cleaned
1/17/2018 9:28:50 AM	Tincats	0003	Rodent Traps	Serviced		No Activity	Cleaned
1/17/2018 9:31:31 AM	Ceiling	0003	Glue Board	Serviced		No Activity	Cleaned
1/17/2018 9:32:13 AM	Ceiling	0004	Glue Board	Serviced		No Activity	Cleaned
1/17/2018 9:34:25 AM	Restroom	0002	Inspection	Serviced		No Activity	Cleaned
1/17/2018 9:34:32 AM	Restroom	0001	Inspection	Serviced		No Activity	Cleaned
1/17/2018 9:35:28 AM	Register	0001	Inspection	Serviced		No Activity	Cleaned



PEST FINDINGS BY WORKORDER

- Lists all instances where pest activity was recorded by the technician. The user can select any combination of pest findings by workorder.

Inspection Timestamp	Zone Name	Station Name	Trap Type	Status	Reason	Pest	Pest Type	Pest Qty
4/29/2019 10:25:40 AM	07 mechanical room	0003	Inspection	Serviced		Beetles	Occasional Invader	2
4/29/2019 10:30:21 AM	06 food preparation	0001	Rodent Traps	Replaced	Change Barcode	Spiders	Spiders	2
4/29/2019 10:32:58 AM	06 food preparation	0004	Rodent Traps	Serviced		Spiders	Spiders	1
4/29/2019 10:59:17 AM	03 exterior	0005	Rodent Traps	Serviced		Beetles	Occasional Invader	1
4/29/2019 11:00:41 AM	04 storage rooms	0001	Inspection	Replaced	Change Barcode	Wasps	Bees/Wasps	5



SANITATION & STRUCTURE RECOMMENDATIONS

- Lists the services in which the technician entered a sanitation and structure recommendation for the customer to address.



Inspection Timestamp	Zone Name	Station Name	Trap Type	Status	Reason	Observation	Action Plan	Observation Category
5/7/2019 8:24:02 AM	10 EXTERIOR	0004 FRONT DOOR JAM	Inspection	Replaced	Change Barcode	Door Gap	Add/Repair Door Sweep	Structure
5/7/2019 8:28:08 AM	03 DINING ROOM	0001 FRONT DOOR ENTRANCE	Inspection	Serviced		Door Gap	Add/Repair Door Sweep	Structure
5/7/2019 8:31:08 AM	12 RECEIVING DOOR	0008 BACK RECEIVING DOOR	Inspection	Serviced		Debris Present	Remove Clutter	Sanitation
5/7/2019 8:39:07 AM	06 STORAGE AREA	0001 RIGHT SIDE DISH SINK	Inspection	Serviced		Moisture Present	Clean Area	Sanitation
5/7/2019 8:41:50 AM	02 OFFICES	0001 DOOR JAM	Inspection	Serviced		Debris Under Shelves	Remove Debris - Customer	Sanitation
5/7/2019 8:43:42 AM	09 DRIVE THRU	0003	Glue Board	Serviced		Moisture Present	Clean Area	Sanitation



Sanitation & Structure Recommendations Trend

- View the number of sanitation and structure recommendations that were entered by the technician over a specific time frame.

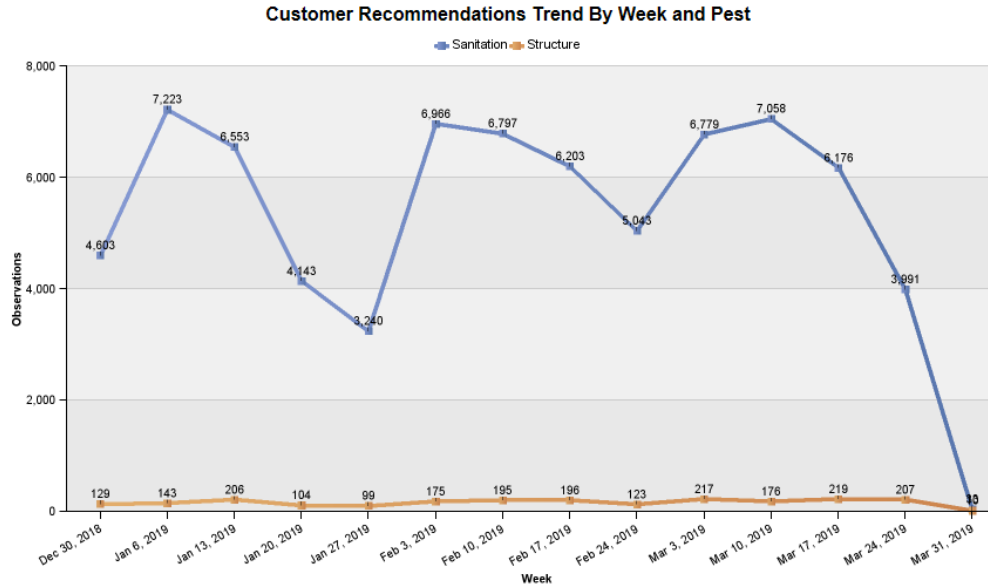

INSITE SERVICE TICKET REPORT

- A service ticket report summary with an overview of services provided by observation and station.

Station Inspections

Employee Entrance

Inspection Timestamp	Zone Name	Station Name	Station Inspection Status	Station Inspection Status Reason	Trap Name	Trap Type	External Trap Type	Trap Type Pest Category
Jan 24, 2018 7:09:02 AM	Employee Entrance	0469	Serviced		Tin Cat Trap	Rodent Traps	0	RodentCrawling
Station Inspection Comments:		No comments entered.						

Observation Recorded

Observation	Action Plan	Observation Category	Count - Observation Finding Record
No Activity	Cleaned	Sanitation	1

Inspection Timestamp	Zone Name	Station Name	Station Inspection Status	Station Inspection Status Reason	Trap Name	Trap Type	External Trap Type	Trap Type Pest Category
Jan 24, 2018 7:09:48 AM	Employee Entrance	0468	Serviced		Tin Cat Trap	Rodent Traps	0	RodentCrawling
Station Inspection Comments:		No comments entered.						

Observation Recorded

Observation	Action Plan	Observation Category	Count - Observation Finding Record
No Activity	Cleaned	Sanitation	1



PEST ACTIVITY FOR MULTIPLE LOCATIONS

- View pest activity at any location that is serviced by Orkin.

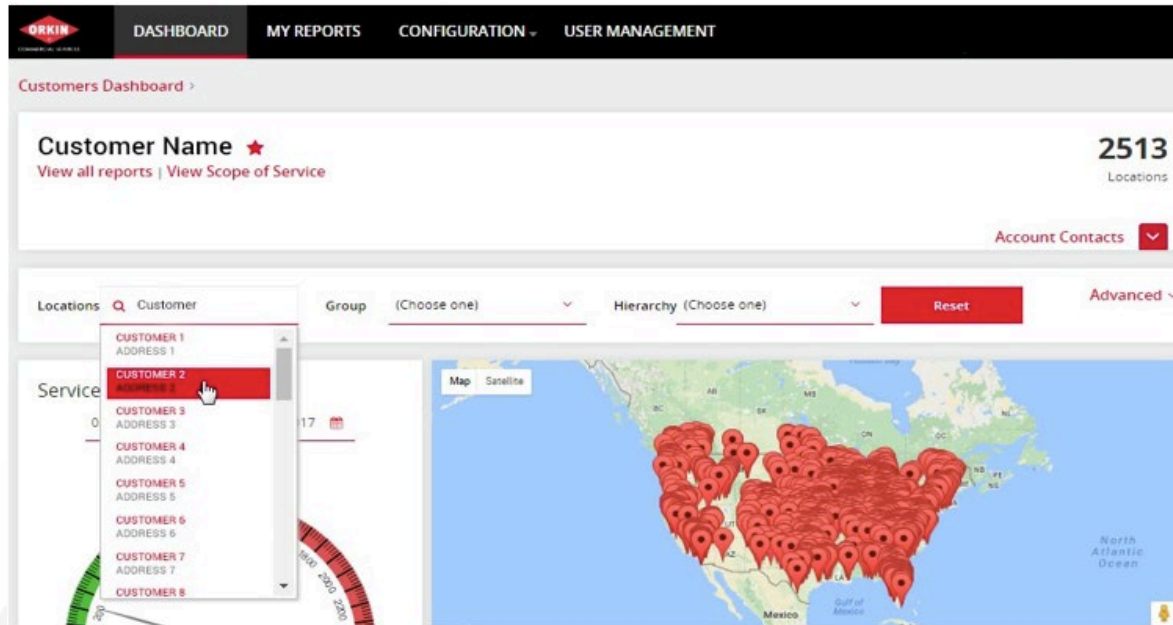

Service Summary by Location

- Identifies the type and number of pests captured over a specific time frame.

Closed Timestamp	Service Ticket	Pest Findings Y or N				Number of Observations	Number of Recommendations	Number of Comments
		Rodents Qty	Roaches Qty	Flies Qty	Birds Qty			
1/8/2019 9:21:00 AM	175624338	N	N	Y	N	0	0	0
1/8/2019 9:21:00 AM	175624338	N	N	Y	N	29	29	0
1/8/2019 9:21:00 AM	175624338	N	N	Y	N	0	0	0
1/8/2019 9:21:00 AM	175624338	N	N	Y	N	0	0	0
2/21/2019 8:47:00 AM	176718961	N	N	Y	N	30	30	0
3/12/2019 9:30:00 AM	177931460	N	N	Y	N	30	30	0
3/12/2019 9:30:00 AM	177931460	N	N	Y	N	0	0	0
4/9/2019 9:05:00 AM	178968077	N	N	Y	N	31	31	0
5/14/2019 9:36:00 AM	180492576	N	N	Y	N	0	0	0
5/14/2019 9:36:00 AM	180492576	N	N	Y	N	0	0	0
5/14/2019 9:36:00 AM	180492576	N	N	Y	N	31	31	0



STATION INVENTORY REPORT BY LOCATION AND TRAP

- Lists station inventory by service location and pest trap.

Trap Type	Trap Name	Count
E. Rodent Bait Station	E. Rodent Bait Station	2
E. Rodent Bait Station - Total		2
Glue Board	Report Card Monitor	1
Glue Board - Total		1
I. Rodent Bait Station	Bait Station	2
I. Rodent Bait Station - Total		2
Inspection	Area	6
	Log Book	1
Inspection - Total		7
Rodent Traps	Tin Cat Trap	6
Rodent Traps - Total		6



InSite Service Ticket Report With Zone Summary

- A work order summary that gives an overview of services provided by each zone at your property.

Zone Summary

06 STORAGE AREA

Observation Recorded

Observation	Action Plan	Observation Category	Count - Observation Finding Record
No Activity	Inspection Provided	Document	1

Pesticide Usage

Pesticide QTY	Pesticide	EPA/PCP Number	Chemical	Pesticide Lot Number	Pesticide UOM	Pesticide Rate of Application - Historical	Pesticide Formulation - Historical	Pesticide Application Method - Historical	License Number	Count - Pesticide Usage Record
4	Glue Board Mouse				EACH		Product Formulation Undefined	Placement		1

Station Summary

Station Inspection Status - Historical	Station Inspection Status Reason - Historical	Count - Station Inspection Record
Serviced		1
Total		1



PESTICIDE USAGE LOG

- Lists all pesticides used during a specific time frame, by location.

Product: TEMPRID FX **EPA:** 432-1544

Active Ingredient: IMIDACLOPRID

Date Treated	Zone Name	Station Name	Method	Formulation	Qty Used	Unit of Measure	Lot #	Applicator	License Number
2/13/2019 9:48:11 AM	01 LOGBOOK	0001 METAL STAND	Crack and Crevice	Liquid	1	OUNCE(S)			
5/8/2019 9:35:02 AM	02 OFFICES	0001 BACK DOOR	Crack and Crevice	Liquid	2	OUNCE(S)			
4/10/2019 9:34:22 AM	03 DINING ROOM	0001A UNDER COUNTER	Crack and Crevice	Liquid	1	OUNCE(S)			
1/9/2019 9:34:49 AM	07 RESTROOMS	0001 DOOR FRAME	Crack and Crevice	Liquid	2	OUNCE(S)			
3/13/2019 9:38:21 AM	07 RESTROOMS	0001 DOOR FRAME	Crack and Crevice	Liquid	2	OUNCE(S)			



PEST FINDINGS ANALYSIS

- Compilation of all data, through any combination of criteria, associated with pest findings. Allows you to customize data according to your specifications.

Trap Filters

Trap Type

Trap

Trap Location Type

Trap Pest Type

Miscellaneous Filters

Branch

Service Type



COMMERCIAL SERVICES

Date Filters

Start Date

End Date

Apply Selected Filters

Inspection Point Filters

Zone

Station

Pest Filters

Pest Type

Pest

Top 15 Total Pest QTY by Zone

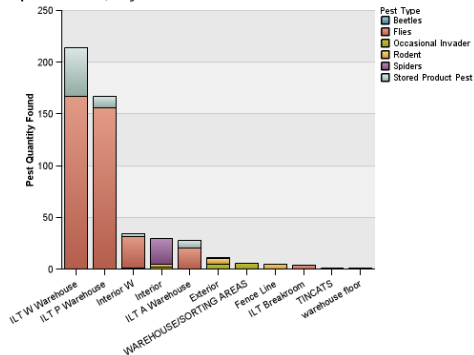

Chart Controls

Group By

Customer

Level 1

Level 2

Level 3

Level 4

Level 5

Level 6

Level 7

Level 8

Level 9

Location(s)

Top 15 Total Pest QTY by Location #



ORKIN

OBSERVATION FINDINGS ANALYSIS

- Compilation of all data from the customer recommendation report. Allows you to customize data according to your specifications.



CORPORATE PEST FINDINGS

- Displays the number of locations that exceed your specific pest thresholds, by month.

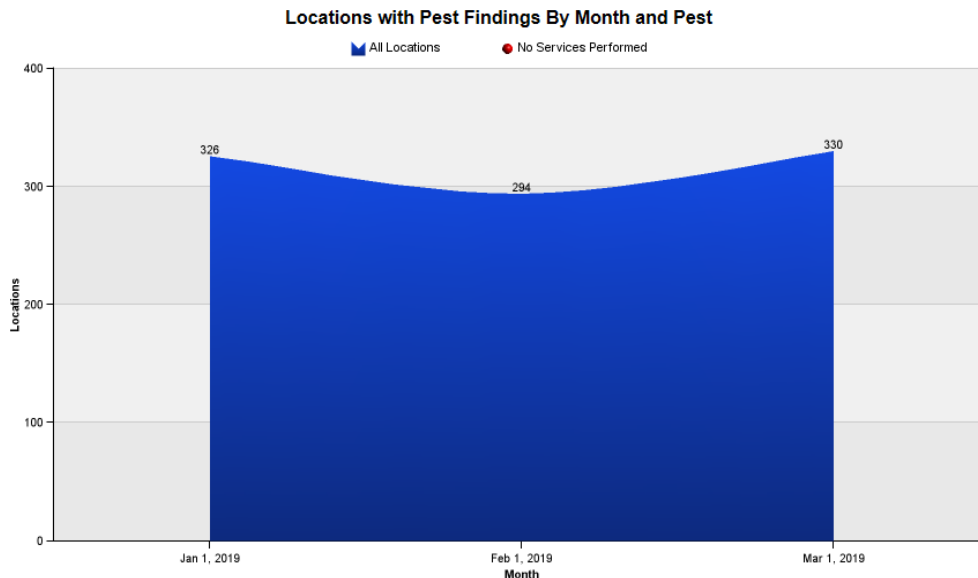

DOWNLOADING REPORTS

- Each report includes “Download Options (formats).” In the dropdown menu, you can choose either PDF or Excel Data formats. Once you choose the format, the report will begin to download. Once the download completes, you can save the report.

Work Order Information						Export Report:		
Location:							Format: PDF Excel 2007 Data Extract	
Account Number:		Servicing Branch:	BR 551 Lansing, MI	Started:	Apr 30, 2019 10:33:00 AM	Synced:		
Ticket Number:		Route:	551-15 Comm	Completed:	Apr 30, 2019 10:53:00 AM	Updated:		Apr 30, 2019 2:55:27 PM
Service Activity:	PC Standard	Servicing Tech:		Total Service Time:	20 minutes			
Work Order Instructions:	FOR SERVICE PLEASE CALL 877 540 6721. 3rd wednesday anytime							
Work Order Comments:	Inspected throughout business. No issues saw. Spoke with manager about making sure dining room area is thoroughly cleaned so an ant issue does not arise. Treated per scope as needed.							





LOGIN AND ACCOUNT REGISTRATION



CUSTOMER LOGIN



- Use the URL below to gain access to your account:
<http://www.orkininsite.com>
- If you are new to this website, please click “Register Here.”
- Forgot your password? Click the “Forgot Password” feature to reset your account.

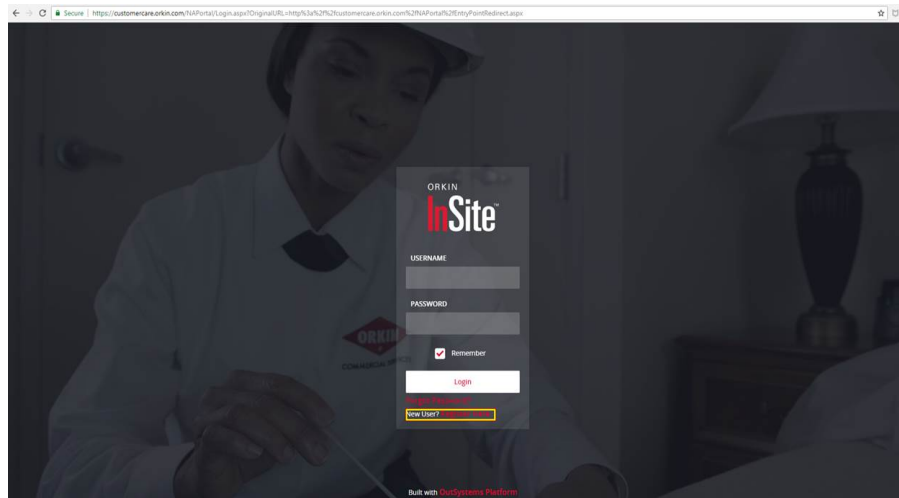

ACCOUNT REGISTRATION



- Fill out the User Registration Form.
- Note that if you've just registered with the customer portal, you should allow 24 hours for any data to update.
- Any changes to the customer portal (i.e. name change) will take 24 hours to update.

User Registration Form

Personal Information	
Have you ever had access to Orkin's Commercial Relations Network prior to this request?*	
<div>Yes</div> <div>No</div>	
Email *	<input type="text"/>
First Name *	<input type="text"/>
Last Name *	<input type="text"/>
Position / Job Title *	<input type="text"/>
Office Phone Number *	<input type="text"/>
Cell Phone Number	<input type="text"/>

Company Information	
Company Name *	<input type="text"/>
Company Address *	<div>Address</div> <div><div>- Select State -</div><div>- Select City -</div></div> <div>Zip Code: e.g. 12345-6789</div>

ACCOUNT REGISTRATION



- Once you register/login to the customer portal, you will be routed to the Location Dashboard. This page allows you to run reports, change your password, get additional help, contact us and logout. If you are an administrator, you will have the ability to perform other tasks.

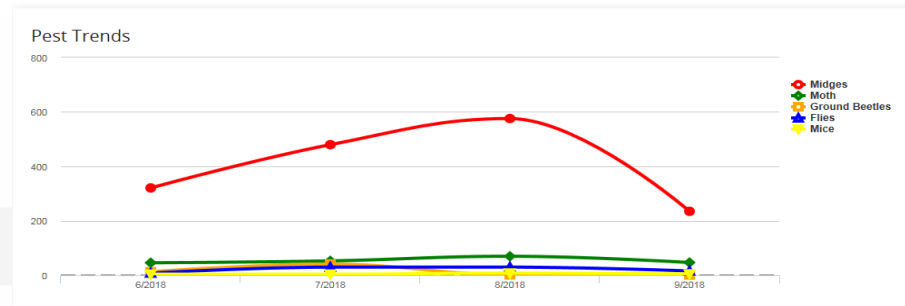
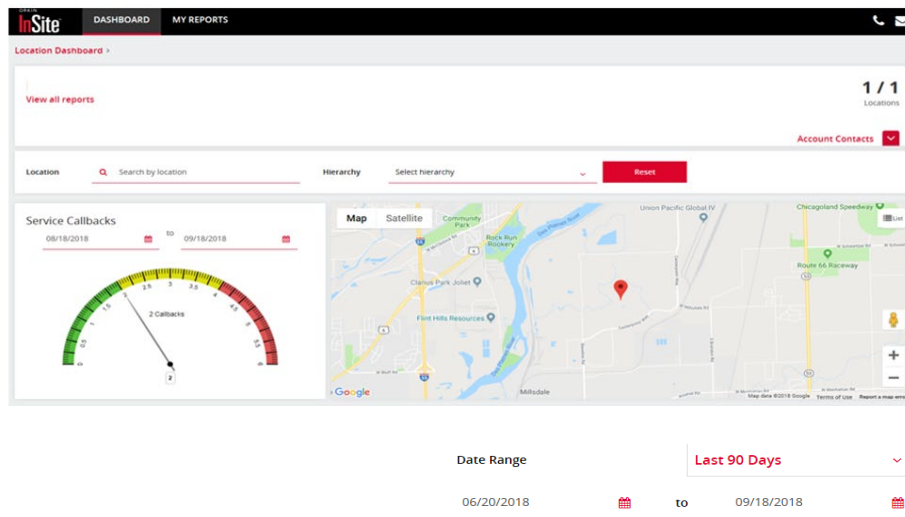



QUESTIONS?





Orkin Key Corporate Personnel Team Resume

Orkin Key Personnel Team Resume			
Technical Services Corporate Resources			
Name	Academic Background	Position Held at Orkin	Years of Experience
Judy Black	Board Certified Entomologist, Certified Professional –Food Safety M.S., Entomology, West Virginia University B.S., Environmental Protection, West Virginia University	Vice President, Quality Assurance and Technical Services	33
Glen Ramsey	Board Certified Entomologist, Certified Food Manager M.S. Entomology, University of Georgia B.S.E.S. Entomology, University of Georgia	Senior Manager, Technical Services	11
Frank Meek	BCE - Board Certified Entomologist	Manager, Technical Services	34
Ben Hottel	Ph.D. Entomology, University of Florida M.S. Entomology, University of Illinois B.S. Agricultural and Consumer Economics, University of Illinois	Manager, Technical Services	11
Ronald D. Harrison	Ph.D., Entomology, University of Georgia M.S., Horticulture, University of Georgia B.S., Plant Science, Agronomy, Horticulture, Utah State University Board Certified Entomologist	Director, International Franchise Technical Services	27
Mike Leisses	B.S. Communications, University of Wisconsin-Oshkosh American Institute of Baking Rollins Leadership Program	Director, National Accounts Customer Care Procedures & Systems	30
Mala Williams	B.A., Business Administration, University of Southern Caribbean American Institute of Baking Texas A & M Emory SQL – Database	Director, Procedures & Systems	20



Orkin Key Corporate Personnel Team Resume

Deborah A Toth	Villanova University – Master’s Certificate, Government Contracting B.S., Psychology, University of Pittsburgh	Government Business Development & Contract Manager	16
Joshua Williams	B.S. , Criminal Justice, Valdosta State University	Government Lead Support	3
TBD		Government Invoicing & A/R Analyst	



Recommended Product Charts

Orkin will provide the copies of SDS/Labels of products upon notice of a contract award. This documents provides a comprehensive list of products, their uses and their formulations.

Please Read These Instructions before Using This Guide

1. This is a guide showing some of the most common and/or most useful approved pesticides for common pests. These charts should guide the selection of products to treat specific pests. This is not a list of all approved pesticide products nor does it necessarily represent the best option for every pest situation (i.e., when more than one product is listed, the order in which they appear is not a ranking of their efficacy).
2. **ALL MATERIALS MUST BE USED ACCORDING TO LABEL DIRECTIONS.** For specific treatment instructions on where and how a particular pesticide should be applied, consult and follow the product label. Remember to wear all required personal protective equipment (PPE) and always review pesticide label precautionary statements and environmental restrictions.
3. Care must be taken not to contaminate food or food contact surfaces (including dishes, silverware, and/or storage cabinets). Items should be removed by the customer before treatment. Any food contact surfaces on which pesticides were applied must be washed by the customer before being used. This applies to both residential as well as commercial customers.
4. Consult your Branch Management, Region Service Manager, or Division Technical/Service Manager with questions or concerns regarding the use of any products prior to application, or for product-related questions regarding target pests not listed in this document. For additional information, contact the Rollins Technical Services Department at (404) 877-4607.

Pesticide Formulations

All pesticide formulations consist of two or more components: a biologically or chemically active portion called the active ingredient (AI) and an inactive portion called the inert ingredient(s). The AI is the part of a formulation that controls the pest while inert ingredients have little or no toxic effects. The inert ingredients can include a carrier (a solvent or mineral clay that 'carries' the active ingredient) and/or adjuvants such as spreaders, stickers/stabilizers, foaming (or de-foaming) agents, or other synergists. A synergist is an additive that helps make the active ingredient 'more active' against a pest. There are many different types of pesticide formulations with specific advantages and disadvantages. Some of the factors to consider when choosing a certain type of pesticide formulation include:

- The type of substrate to which the pesticide will be applied
 - (e.g., concrete, wood, soil, tiles, carpet)
- Potential exposure to non-target organisms
 - (e.g., humans, pets, other animals)
- Potential disturbance of the pesticide application area
 - (e.g., exposure to sunlight, high temperature, cleaning, removal)
- Type of application equipment
 - (e.g., hand held compression sprayer, duster, power sprayer, foam machine, backpack sprayer, bait station)
- Environmental safety
 - (e.g., chance for water runoff/erosion, proximity of wells and bodies of water, use of the area by humans and pets)

Types of Pesticide Formulations (followed by abbreviation in parentheses)

Aerosol (A)

Aerosols are usually liquid formulations of an AI and solvent in a ready-to-use product available in sealed pressurized containers. A's are very portable and easily stored, but there is risk of skin exposure, inhalation exposure or flammability. A's will rupture if punctured or overheated. It can be difficult to make direct application to target sites or pests without can attachments or injector tips. A's can be applied using crack and crevice, foam treatment, general surface spray, space treatment, spot (2 square feet or less), or ultra-low volume (ULV) methods. Applicators should wear gloves and consider respiratory protection when using.

Bait (B)

Baits are a formulation of a pesticide designed to be eaten or swallowed, are generally marketed as ready-to-use and can be dispensed as a dust, granular, pellet or a semi-liquid gel or liquid. B's usually contain different materials to make the formulation 'taste good' to the pest. Pesticide baits can be contained within a specially designed station or come in a ready-to-use device for directed application that are intended to reduce the chance of non-target exposure. B's are typically easy to apply. However, they must compete with other available foods and can be attractive to humans or domestic animals. B's can be applied using bait placement, broadcast, crack and crevice, placement, or void treatment methods. Applicators should wear gloves and ensure placements are not accessible to non-targets.

Capsulated Suspension or Microencapsulated (CS or ME)

Microencapsulated formulations are composed of a liquid or dry pesticide AI covered in a plastic coating. These are mixed with water and used in the same way as other liquid formulations. After application, the plastic coating slowly breaks down and releases the active ingredient(s). Due to a slower release of the active ingredient, these pesticides are often more effective over a longer period of time. There is usually less odor and fewer hazards to the skin than other formulations. However, CS/ME formulations may pose increased hazards to bees. These formulations can be applied by crack and crevice, foam treatment, general surface spray, mist application, space treatment, spot (2 square feet or less), or void treatment.

Dusts (D)

Dusts are ready to use and typically contain less than 10% AI by weight. These require no mixing and are often used when moisture from a liquid application might cause damage. They are effective in hard to reach indoor areas and are easy to apply. However they can drift off target and are easily moved by air and water. However, certain dust products (boric acid-based and desiccants) can be mixed in solution and applied. Dry D's do not adhere to surfaces easily and it can be difficult to get even distribution when applying. D's can be applied by crack and crevice, foam treatment, and void treatment.

Emulsifiable Concentrate (EC)

Emulsifiable concentrates are a liquid formulation consisting of a pesticide mixed with a solvent and an emulsifier (e.g., detergent like material that aids in pesticide suspension). EC's, when mixed, appear milky. EC's will remain mixed for hours with moderate agitation as the detergent prevents the AI from settling out of the tank mix. EC's are easy to mix, won't clog application equipment screens or nozzles, and typically leave no visible residue on treated surfaces. This formulation contains solvents which makes it easily absorbed through skin of humans or animals (Follow label PPE requirements!) as well as by porous surfaces. This formulation type may also damage application equipment if left in equipment overnight, discolor painted finishes, or harm plants. EC's can be applied using crack and crevice, foam application, general surface spray, or spot (2 square feet or less) methods.

Flowables (F)

A flowable formulation combines many of the characteristics of EC's and wettable powders. Manufacturers use these formulations when the AI is a solid that does not dissolve in either water or oil. The active ingredient, impregnated on a substance such as clay, is ground to a very fine powder. The powder is then suspended in a small amount of liquid. The resulting liquid product is quite thick. They require moderate agitation to keep them in suspension and leave visible residues similar to those of wettable powders. F's are easy to handle and apply. Always shake them thoroughly before pouring and mixing. F's can be applied using crack and crevice, general surface spray, mist application, or spot (2 square feet or less) methods. Applicators should wear gloves when mixing or applying.

Granule (G)

Granular pesticides are dry formulations with particle sizes that are not uniform and much larger than dust. G formulations must be kept dry until application. G's act as contact insecticides and are not intended to be eaten by the target pest. G's are designed to absorb moisture and slowly release the AI; however, heavy rains after application can shorten the residual life of this type of pesticide formulation. Just the same, dry conditions will not allow G's to release the pesticide. G's are pre-mixed and have a low drift hazard due to their large particle size. Particle size can affect the ability for uniform application. G's can be applied using broadcast method. Applicators should wear gloves and ensure that G's are not dispersed into water sources unless labeled for that application.

Ready-To-Use (RTU)

Ready-To-Use pesticides are pre-mixed liquid pesticide products. They contain a single or number of AI's and a dilution agent (typically either a solvent or water based solution). RTU products require no further dilution and often contain less than 1% AI. RTU application methods include: crack and crevice, general surface spray, space treatment, spot treatment (2 square feet or less), and void treatment. PPE requirements will be product specific and depend on the type of dilution agent in the RTU product.

Suspension Concentrate (SC)

Suspension concentrates contain tiny particles of AI suspended in a liquid (usually water). For AI's that are denser than water (most are), suspension agents are added to prevent the solid AI from settling in the packaged product. SC's allow products previously available as dry formulations (e.g. D or wettable powders) to be in liquid form, further reducing applicator safety issues associated with them. SC's are typically easy to use and provide long residual activity. However, SC's are prone to settling to the bottom of tank-mix solutions and agitation is often required. Additionally, SC's in solution are often quite foamy (many SC formulated products already contain de-foaming agents in their inert ingredients) and may leave a visible residue on surfaces (test a small section first before spraying an entire area). SC formulations can be applied by crack and crevice, foam treatment, general surface spray, space treatment, spot (2 square feet or less), or void treatment.

Water Soluble Granules (WSG)

Water soluble granules dissolve readily when mixed with water and form a true solution. After they are mixed, no additional agitation is necessary. These have the advantages of wettable powders but less inhalation hazard due to being a granule instead of a dust. There is usually a high amount of AI by weight (up to 95%). When used, much of the pesticide remains on the surface of treated porous materials such as concrete and untreated wood. WSG's can be applied by crack and crevice, general surface spray, space treatment, spot (2 square feet or less), or void treatment.

Wettable Powder (W or WP)

Wettable powders are a dry formulation that has the AI attached to a dust-like (powder) particle. A wetting agent is added to the powder so it can be mixed with water prior to application. The wetting agent increases the ability of the powder to mix with water to form a suspension. A suspension means that the WP stays suspended (floating/sinking) in the dilution. This formulation remains on the surface of porous materials. WP's typically have low toxicity to plants and are not readily absorbed by the skin of humans or domestic animals. WP's require frequent agitation to keep the powder from settling to the bottom of the tank and can leave a visible residue on dark surfaces. WP's can be applied using crack and crevice, foam treatment, general surface spray, or spot (2 square feet or less) methods. Applicators should wear gloves and respiratory protection (when mixing).

Ultra-Low Volume (ULV)

Ultra-low volume formulations contain a concentrated form of the AI in a carrier or solvent (e.g. water or oil-based concentrates). ULV formulations require special application equipment (typically a gasoline or electric fogger). They are applied at very low volumes usually outdoors or in limited indoor settings as a contact insecticide. ULV application methods include fogging and space treatments. ULV treatments provide quick knockdowns and leave little visible residue on treated surfaces. Oil-based ULV products contain solvents that may damage plastics/rubber, wire-insulation, or sprayer-parts and are also readily absorbed through the skin of animals and into porous surfaces. ULV application equipment calibration and application must be carefully conducted because of the high concentration of active ingredient. Applicators applying ULV formulations should wear all label-required PPE including respiratory protection due to the significant risk of inhalation exposure.

Ants			
<p>Ants are social insects. Foraging individuals will be seen but the majority of individuals will be in the colony nest. As such, treatments must address the main colony, not just foraging adults. Find and treat the main colony if at all possible. Baits are a great option because the foraging adults will bring the product back and distribute it throughout the colony. Each different species of ant has different feeding preferences and nesting locations which may change over the course of the year. Correct identification of the ant species is necessary to pick the most effective bait or chemical treatment.</p> <p>Examples include: Argentine, acrobat, carpenter, crazy/tawny crazy, odorous house, pavement, etc.</p>	Product Type	Formulation	Recommended Product Choices
	Liquid sprays	WSG	Arilon
		WSG	Alpine WSG
		SC	Phantom Termiticide Insecticide
		SC	Termidor SC Termiticide Insecticide
		WP	Transport GHP
		F	Talstar Professional
		SC	Temprid FX
	Dusts	D	Alpine D Dust Insecticide
		D	BorActin
		D	DeltaDust
		D	Drione
	Baits/Granules	B	Advance Baits (Gel, Granular, Station)
		B	Advion Ant Bait Arena/Gel
		B	Intice Baits (Gel, Granular, Station)
		B	Maxforce Baits (Gel, Granular, Station)
		G	Talstar PL Granular
		G	Taurus Trio G
	RTUs	A	Phantom II Pressurized Insecticide

Bed Bugs			
<p>Bed bugs are parasites on humans and feed on human blood. When not feeding, they are hiding in cracks, crevices, mattress seams or folds, or other concealed areas near a potential host. Bed bugs are frequently found around areas where people rest (beds, couches, chairs, etc.) but can be found nearly anywhere (because they can be hitchhikers on humans as they move from place to place). It's important to inspect thoroughly to find all areas bed bugs may be harbored in and treat accordingly.</p>	Product Type	Formulation	Recommended Product Choices
	Liquid sprays	SC	Phantom Termiticide Insecticide
		WP	Transport GHP
		SC	Temprid FX
	Dusts	D	Cimexa
		D	Drione
	RTUs	A	Bedlam Insecticide
		A	PT Phantom II Pressurized Insecticide
		A	PT Alpine Flea and Bed Bug Aerosol
		RTU - Liquid	Sterifab

Cockroaches

Cockroach management requires thorough inspection, sanitation, exclusion, and monitoring. Inspection and monitoring of populations will help find hotspots and sanitation issues that must be addressed. IGRs are very important for long term reductions in areas with chronic sanitation issues. Baits are often the first choice because a single cockroach can transfer the product back to harborage spots thereby impacting many other individuals. Correct identification of the cockroach species will lead to a better understanding of feeding behavior, likely harborage areas, and more effective control.

Examples include: German, American, Oriental, brown banded, woods, etc.

Product Type	Formulation	Recommended Product Choices
Liquid sprays	WSG	Alpine WSG
	SC	Phantom Termiticide Insecticide
	CS/ME	Onslaught
	SC	Temprid FX
	WP	Transport GHP
	F	Talstar Professional
Dusts	D	Alpine D Dust Insecticide
	D	BorActin
	D	Cimexa
	D	Drione
Baits/Granules	B	Advion Cockroach Bait Arena/Gel
	B	Alpine Cockroach Gel Bait
	B	Avert Dry Flowable Cockroach Bait
	B	Intice 10 Perimeter Bait
	B	MaxForce Baits (Bait Arena,Gel, Granular)
	B	Talstar PL Granular
	B	Vendetta Plus Cockroach Gel Bait
ULV Space Treatment	ULV	Pyrocid 100/300
	ULV	ULD BP 100/300
IGRs	EC	Gentrol IGR Concentrate
	EC	NyGuard IGR Concentrate
	EC	Tekko Pro IGR Concentrate
RTUs	RTU - Device	Gentrol Point Source
	A	PT Phantom II Pressurized Insecticide

Fabric Pests			
<p>These pests are developing and feeding on some type of animal based product such as wool, hides, or taxidermy specimens. Identification and elimination of the infested item are keys to stopping the spread of these insects. Monitoring with pheromone traps will help to pinpoint infestation areas.</p> <p>Examples include: carpet beetles, clothes moths, etc.</p>	Product Type	Formulation	Recommended Product Choices
	Liquid sprays	CS/ME	Demand CS
		SC	Temprid FX
		WP	Transport GHP
	Dusts	D	Cimexa
		D	DeltaDust
	ULV Space Treatment	ULV	Pyrocide 100/300
		ULV	ULD BP 100/300
	IGRs	EC	Nyguard IGR Concentrate
		EC	Tekko Pro IGR Concentrate

Fleas and Ticks			
<p>Fleas and ticks can be found outside and inside and are commonly transferred by pets. Outside treatments may reduce overall populations but inside treatments may be necessary. Never treat animals and refer pet owners to veterinarians for that treatment.</p> <p>Examples include: cat fleas, dog ticks, deer ticks, lone star ticks, etc.</p>	Product Type	Formulation	Recommended Product Choices
	Liquid sprays	CS/ME	Demand CS
		CS/ME	Onslaught
		SC	Tempo SC Ultra
		F	Talstar Professional
	Dusts	D	Cimexa
		D	DeltaDust
	IGRs	EC	Nyguard IGR Concentrate
		EC	Precor IGR Concentrate
		EC	Tekko Pro IGR Concentrate
	RTUs	A	Bedlam Insecticide
		A	Precor 2625 Premise Spray
		A	PT Alpine Flea and Bed Bug Aerosol

Flies			
<p>Large flies and small flies differ significantly in habitat preference, but their presence in an area is most often associated with a sanitation issue. Eliminating that issue is the first step, followed by chemical product application, if necessary. Work with the customer to find the source and eliminate or reduce it. Check all openings (windows, doors, etc.) to prevent outside issues from moving inside the structure. Insect light traps and glue boards should be utilized to monitor treatment efficacy and further reduce populations.</p> <p>Examples include: blow/bottle, flesh, house, fruit, fungus (gnat), moth (drain), phorid, etc.</p>	Product Type	Formulation	Recommended Product Choices
	Liquid sprays	WSG	Alpine WSG
		CS/ME	Demand CS
		F	Talstar Professional
		SC	Tempo SC Ultra
		WP	Transport GHP
	Dusts	D	BorActin
		D	Nibor-D
	Baits/Granules	G	Starbar Golden Malrin Fly Bait
		G	MaxForce Fly Spot Bait
		G	MaxForce Granular Fly Bait
	ULV Space Treatment	ULV	Pyrocide 100/300
		ULV	ULD BP 100/300
	IGRs	EC	Nyguard IGR Concentrate
		EC	Tekko Pro IGR Concentrate
	RTUs	A	PT Alpine Pressurized Fly Bait
		A	PT 565 Plus XLO Formula 2

Mosquitoes			
<p>Mosquitoes breed in wet environments. Standing water should be eliminated if possible. Treatment for immature stages relies primarily on either granule or pellet (BTI based or IGRs) applied to the water source. The most common treatment for adults is residual spray to potential resting areas (over grown foliage, dark shaded areas, etc.). Ultra-low volume (ULV) applications may sometimes be performed. Refer to the mosquito service guidelines for specific information.</p>	Product Type	Formulation	Recommended Product Choices
	Liquid sprays	CS/ME	Demand CS
		CS/ME	Onslaught FastCap
		F	Talstar Professional
	Baits/Granules	G	FourStar BTI CRG
	ULV/Space Treatment	A	PT Pro-Control Plus Aerosol
		ULV	Pyrocide 100/300
	IGRs	G	Altosid Pellets WSP
		G	Altosid Pro-G

Occasional Invaders

Occasional invaders are often a seasonal issue and will emerge with the onset of a certain time of year. These are outside issues but will build up in high numbers and enter structures. While causing little to no damage, they are a nuisance. Every effort should be made to exclude them from entering structures by checking and sealing all openings (doors, windows, etc.). Outside perimeter treatments are often helpful to deter individuals from being near the structure.

Examples include: boxelder bugs, clover mites, cluster flies, crickets, earwigs, ground beetles, millipedes, pill bugs, stink bugs, lady beetles, etc.

Product Type	Formulation	Recommended Product Choices
Liquid sprays	WSG	Alpine WSG
	CS/ME	Demand CS
	F	Talstar Professional
	SC	Temprid FX
	WP	Transport GHP
Dusts	D	BorActin
	D	Cimexa
	D	DeltaDust
	D	Drione Insecticide
Baits/Granules	B	InTice 10 Perimeter Bait
	G	Advion Insect Granule
	G	Talstar PL
	B	Maxforce Complete Granular Insect Bait
IGRs	EC	Nyguard IGR Concentrate
	EC	Tekko Pro IGR Concentrate
RTUs	A	PT Cy-Kick CS Pressurized Insecticide
	A	PT Phantom II Pressurized Insecticide

Pantry/Stored Product Insects

<p>These insects will infest food, feed, and animal-based products. If infested product can be found, dispose of it immediately to prevent nearby products from becoming infested. Sanitation and exclusion are keys to reducing populations and preventing re-infestations. Extreme care should be taken when applying pesticides to ensure no contamination of food or food contact surfaces.</p> <p>Examples include: flour beetles, warehouse beetles, cigarette beetles, Indian meal moths, weevils, etc.</p>	Product Type	Formulation	Recommended Product Choices
	Liquid sprays	CS/ME	Demand CS
		SC	Tempo SC Ultra
	Dusts	D	Cimexa
		D	DeltaDust
	Baits/Granules	B	Maxforce FC Magnum
	ULV Space Treatment	ULV	Pyrocid 100/300
		ULV	Shockwave
		ULV	ULD BP 100/300
	IGRs	RTU - Device	Cidetrak IMM
		EC	Gentrol IGR Concentrate
		EC	Nyguard IGR Concentrate
		EC	Tekko Pro IGR Concentrate
	RTUs	A	PT Cy-Kick CS Pressurized Insecticide
		A	PT Tri-Die Pressurized Dust

Rodents (Mice and Rats)

<p>Rodent baits must be applied in a locking, secured bait station. Bait stations should be strategically placed along rodent pathways for optimal results. Baits should be rotated on a regular basis (dependent upon service agreement, rodent pressure, environmental conditions, etc.), making sure to rotate the active ingredient. Non-toxic baits and lures may be helpful in identifying activity and enticing rodents to traps.</p>	Product Type	Formulation	Recommended Product Choices
	Block Baits	B	Contrac with Lumitrack
		B	Ditrac All Weather Blox
		B	Fastrac All Weather Blox
		B	Final All Weather Blox
		B	Terad 3 Blox
	Soft Baits	B	Final Soft Bait with Lumitrack
		B	First Strike Soft Bait
	Pellets	B	Contrac Bulk Pellets
	Non-Toxic	B	Detex Blox with Lumitrack
		B	Provoke Mouse/Rat Attractant
	Products for Other Species	B	Kaput D Pocket Gopher Bait
		B	PCQ Pro Pelleted Rodent Bait
		B	Talpirid Mole Bait
		B	Wilco Ground Squirrel Bait

Scorpions and Spiders

<p>Though typically considered beneficial since they eat insects and other arthropods, scorpions and spiders can invade structures. Check all exclusion points to ensure they cannot gain entry into structures. Outside perimeter treatments are beneficial in helping keep them away from structures. Sanitation (keeping the outside clean, neat, and debris-free) will ensure smaller outside populations. Spider webs should be removed with a Webster.</p>	Product Type	Formulation	Recommended Product Choices
	Liquid sprays	CS/ME	Demand CS
		EC	EcoVia EC
		CS/ME	Onslaught FastCap
		SC	Temprid FX
	Dusts	D	Alpine D Dust Insecticide
		D	Drione Insecticide
	Baits/Granules	G	Talstar PL Granular
	RTUs	A	PT Tri-Die Pressurized Dust

Stinging Insects

<p>It is important to find and treat the nest for full efficacy. Honey bees are of special concern due to being beneficial pollinators and chemical treatments are not recommended or might even be unlawful (consider contacting a local beekeeper to relocate the hive). Overall, populations can be reduced by cleaning up food sources so adults will forage elsewhere.</p> <p>Examples include: bumblebee, carpenter bee, honey bee, hornets, paper wasps, yellow jackets, etc.</p>	Product Type	Formulation	Recommended Product Choices
	Liquid sprays	CS/ME	Demand CS
		SC	Tempo SC Ultra
		F	Talstar Professional
		WP	Tempo Ultra WP
	Dusts	D	Alpine D Dust Insecticide
		D	DeltaDust
		D	Tempo 1% Dust
	RTUs	A	PT Wasp Freeze II

Orkin Franchise List

August 2020

NO	TYPE	STATUS	NAME	ADDRESS	CITY	STATE	ZIP	OFFICE	CELL PHONE	Orkin Office Email	Owner Name	OWNER GENDER	Orkin Owner Email	Master Email	Orkin Division
901	D	A	CAPITAL SOLUTIONS OF BIG BEND, INC.	4800 WOODLANE CIRCLE	TALLAHASSEE	FL	32303	(850) 575-9177	(850) 528-2020	fr901-CustSvc@orkin.com	Debbie & Bill Wert	F	FR901-Owner@orkin.com	bill@orkinsolutions.com	Southeast Division
902	D	A	B.I.T.E.S. Pest Solutions, INC.	1720 Commerce Road	ATHENS	GA	30607	(706) 546-1051	(404) 915-5536	fr902-CustSvc@orkin.com	Elizabeth & Tom Lenahan	F	FR902-Owner@orkin.com	thlenahan@athens-orkin.com	Southeast Division
903	D	A	RAM Quality Services, LLC	12649 State Hwy 30	COLLEGE STATION	TX	77845	(979) 690-8622	(806) 584-5588	fr903-CustSvc@orkin.com	Merritt Vaughn	M	FR903-Owner@orkin.com	prvaughn@suddenlink.net	South Central Division
905	D	A	JHTG, INC.	8230 East Pecos Dr	PRESBOTT VALLEY	AZ	86314	(928) 567-5100	(928) 821-2241	fr905-CustSvc@orkin.com	Tim Goeringer & Matt Golleher	M	FR905-Owner@orkin.com	tgoeringer@orkinaz.com	Pacific Division
906	D	A	ALL BAMA, INC.	3121 Wesley Way	DOTHAN	AL	36305	(334) 797-1137	(334) 797-9634	fr906-CustSvc@orkin.com	Dave Paine	M	FR906-Owner@orkin.com	dotditt@aoi.com	South Central Division
908	D	A	GOODROW, INC.	1764 W I-65 Service Rd, South	MOBILE	AL	36693	(251) 666-7507	(251) 298-7506	fr908-CustSvc@orkin.com	Keith Gaudreault	M	FR908-Owner@orkin.com	keith@orkinnow.com	South Central Division
911	D	A	REDCO, INC.	161 N Bay View Drive	VILLA RICA	GA	30180	(770) 832-8671	(404) 933-0818	fr911-CustSvc@orkin.com	Dawson Redmon	M	FR911-Owner@orkin.com	dawsonredmon@gmail.com	Southeast Division
912	D	A	J N BERRY, LLC	#1 Wildwood Dr	PARKERSBURG	WV	26101	(304) 485-4458	(606) 344-2911	fr912-CustSvc@orkin.com	Robert Helton	M	FR912-Owner@orkin.com	Rhelton.usmc@gmail.com	Midwest Division
913	D	A	SAWYER, INC.	107 West 43rd Street	BOISE	ID	83714	(208) 658-1066	(208) 407-5380	fr913-CustSvc@orkin.com	Todd Sawyer	M	FR913-Owner@orkin.com	tsawyer@orkinidaho.com	Pacific Division
914	D	A	GRINNING BULL LLC	3712 Sherwood Way	SAN ANGELO	TX	76901	(325) 653-1338	(254) 485-9263	fr914-CustSvc@orkin.com	Lisa Willett Walker	F	FR914-Owner@orkin.com	theorkinlady@gmail.com	South Central Division
915	D	A	DEVILDOGG LLC	4116 McKnight Rd	TEXARKANA	TX	75503-0921	(903) 793-1640	(606) 344-2911	fr915-CustSvc@orkin.com	Robert Helton	M	FR915-Owner@orkin.com	Rhelton.usmc@gmail.com	South Central Division
916	D	A	JP&G, INC.	3403 Hardy St	HATTIESBURG	MS	39402	(601) 582-3282	(601) 467-8220	fr916-CustSvc@orkin.com	John Horn	M	FR916-Owner@orkin.com	jphorn1121@gmail.com	South Central Division
917	D	A	TSATL, LLC	1020 County Line Road	SIKESTON	MO	63801	(636) 375-3363	(314) 346-0303	fr917-CustSvc@orkin.com	Terry Woods	M	FR917-Owner@orkin.com	Terry_Woods@hotmail.com	South Central Division
918	D	A	BC CAMPBELL, INC.	302 Mt. Cross Rd	DANVILLE	VA	24540	(434) 379-2922	(434) 334-2963	fr918-CustSvc@orkin.com	Stan Lawton	M	FR918-Owner@orkin.com	orkindanville@gmail.com	Northeast Division
920	D	A	FULL CIRCLE PEST CONTROL, INC.	2943 SW Williston Rd	GAINESVILLE	FL	32608	(352) 378-1501	(850) 528-2020	fr920-CustSvc@orkin.com	Bill Wert	M	FR920-Owner@orkin.com	bill@orkinsolutions.com	Southeast Division
922	D	A	DOUBLE D ENTERPRISES, LLC	4029 Greensboro Ave, Suite D	TUSCALOOSA	AL	35405	(205) 759-5775	(205) 292-7952	fr922-CustSvc@orkin.com	Dwayne Hazel	M	FR922-Owner@orkin.com	doubled922@gmail.com	South Central Division
924	D	A	BARKER'S BUGS, INC.	183 Crystal Springs Rd	HOMER	GA	30547	(706) 778-6695	(706) 424-0163	fr924-CustSvc@orkin.com	Kirk/Lisbeth Barker	F	FR924-Owner@orkin.com	orkin@windstream.net	Southeast Division
925	D	A	AET SERVICE, INC.	2320 Thompson Way, Suite G	Santa Maria	CA	93455	(805) 341-3445	(805) 305-3892	fr925-CustSvc@orkin.com	Tim Mahan	M	FR925-Owner@orkin.com	timothy.mahan@orkinslo.com	Pacific Division
926	D	A	CHRISTY JARESH, INC.	#40 Motors Drive	SHERMAN	TX	75092	(903) 893-7459	(940) 867-2931	fr926-CustSvc@orkin.com	Christy Jaresh	F	FR926-Owner@orkin.com	CkAt3266@aol.com	South Central Division
927	D	A	HELTACO, INC.	506 N. Depot Street	CORBIN	KY	40701	(606) 528-2212	(606) 344-2911	fr927-CustSvc@orkin.com	Robert Helton	M	FR927-Owner@orkin.com	Rhelton.usmc@gmail.com	Midwest Division
928	D	A	NY-PENN PEST SYSTEMS, INC.	2630 South Work Street	FALCONER	NY	14733	(716) 664-5470	(716) 397-1645	fr928-CustSvc@orkin.com	Alene & Dale Peterson	F	FR928-Owner@orkin.com	orkin945@windstream.net	Northeast Division
931	D	A	JP&G II, INC.	1313 Delaware	McComb	MS	39648	(601) 684-4932	(601) 467-8220	fr931-CustSvc@orkin.com	John Horn	M	FR931-Owner@orkin.com	jphorn1121@gmail.com	South Central Division
932	D	A	TSALD, LLC	1808 Vandiver Drive	COLUMBIA	MO	65202	(573) 474-9407	(314) 346-0303	fr932-CustSvc@orkin.com	Terry Woods	M	FR932-Owner@orkin.com	Terry_Woods@hotmail.com	South Central Division
933	D	A	CENTIPEDE ENTERPRISES, INC	331-C Enterprise Dr.	Phillipsburg	PA	16866	814-626-8711	(540) 632-2847	fr933-CustSvc@orkin.com	Chuck Sheaffer	M	FR933-Owner@orkin.com	csheaffer@pestservicepros.com	Northeast Division
934	D	A	WILSON'S PEST MANAGEMENT	5899 Coca Cola Blvd	Columbus	GA	31909		(770) 910-4864	fr934-CustSvc@orkin.com	Jay Wilson	M	FR934-Owner@orkin.com	orkin.columbus22@gmail.com	Southeast Division
935	D	I	United Financial Services, Inc.	3319 Hamilton St - Unit O	Bismarck	ND	58503	701-290-5626	(701) 290-5626	fr935-CustSvc@orkin.com	Todd Wandler	M	FR935-Owner@orkin.com	trw@midco.net	Midwest Division
939	D	A	AMS PC, INC.	629 Entler Avenue, Suite 43	CHICO	CA	95928	(530) 566-1749	(530) 624-3079	fr939-CustSvc@orkin.com	Stephen Hale	M	FR939-Owner@orkin.com	amhale@orkinnorcal.com	Pacific Division
942	D	A	RATT, INC.	800 Shoemaker Avenue	Shoemakersville	PA	19555	(610) 336-0344	(717) 648-6971	fr942-CustSvc@orkin.com	Roger Woodyard	M	FR942-Owner@orkin.com	Rwoodyard@rattinc.net	Northeast Division
943	D	A	IB ENTERPRISES, LLC	2111 US 78 E	Anniston	AL	36207	(256) 831-2037	(256) 679-6757	fr943-CustSvc@orkin.com	Kenny Ivey	M	FR943-Owner@orkin.com	williamvey@bellsouth.net	South Central Division
945	D	A	GRINNING BULL, LLC	611 Shiloh Rd, Ste #10	LAREDO	TX	78045	(956) 722-3531	(254) 485-9263	fr945-CustSvc@orkin.com	Lisa Willett Walker	F	FR945-Owner@orkin.com	orkin945@sbcglobal.net	South Central Division
947	D	A	RATT, INC.	1021 N Washington St	WILKES-BARRE TWP	PA	18705	(570) 970-2951	(717) 648-6971	fr947-CustSvc@orkin.com	Roger Woodyard	M	FR947-Owner@orkin.com	Rwoodyard@rattinc.net	Northeast Division
949	D	A	ORKIN OF THE VILLAGES, INC.	1323 Sheller Rd	LEESBURG	FL	34748	(352) 787-1357	(352) 217-5565	fr949-CustSvc@orkin.com	Joel Lussier	M	FR949-Owner@orkin.com	orkinofthevillages@aol.com	Southeast Division
950	D	A	RLHelton, LLC	225 Tollage Creek Rd	PIKEVILLE	KY	41501	(616) 344-2911	(606) 344-2911	fr950-CustSvc@orkin.com	Robert Helton	M	FR950-Owner@orkin.com	Rhelton.usmc@gmail.com	Midwest Division
951	D	A	JFI, LLC	3212 Van Ave	JONESBORO	AR	72401		(870) 316-1468	fr951-CustSvc@orkin.com	Mike Jones	M	FR951-Owner@orkin.com	mikejones.jfi@gmail.com	South Central Division
952	D	A	AET SERVICES, INC.	6 Hangar Way	MONTEREY	CA	95076	(831) 228-1466	(805) 305-3892	fr952-CustSvc@orkin.com	Tim Mahan	M	FR952-Owner@orkin.com	timothy.mahan@orkinslo.com	Pacific Division
953	D	A	GOODROW SOLUTIONS, INC.	1616 Meadows Lane	VIDALIA	GA	30474	(912) 537-1234	(251) 298-7506	fr953-CustSvc@orkin.com	Keith Gaudreault	M	FR953-Owner@orkin.com	keith@orkinnow.com	Southeast Division
954	D	A	TSAT INC	1020 Main Street	IMPERIAL	MO	63052	(636) 223-2212	(314) 346-0303	fr954-CustSvc@orkin.com	Terry Woods	M	FR954-Owner@orkin.com	Terry_Woods@hotmail.com	South Central Division
956	D	A	TSATL2, LLC	1732 Bridge Street	PADUCAH	KY	42003	(636) 375-3363	(314) 346-0303	fr956-CustSvc@orkin.com	Terry Woods	M	FR956-Owner@orkin.com	Terry_Woods@hotmail.com	Midwest Division
957	D	A	RATT, INC.	4450 Paxton Street	HARRISBURG	PA	17111	(717) 657-9063	(717) 648-6971	fr957-CustSvc@orkin.com	Roger Woodyard	M	FR957-Owner@orkin.com	Rwoodyard@rattinc.net	Northeast Division
958	D	A	RATT, INC.	353 S. Potomac Street	Waynesboro	PA	17268	(301) 971-4144	(717) 648-6971	fr958-CustSvc@orkin.com	Roger Woodyard	M	FR958-Owner@orkin.com	Rwoodyard@rattinc.net	Northeast Division
959	D	A	RMKPC, INC.	1218 11th Avenue	MERIDIAN	MS	39301	(601) 482-6003	(601) 486-3275	fr959-CustSvc@orkin.com	Michael King	M	FR959-Owner@orkin.com	orkinmeridian@aol.com	South Central Division
960	D	A	BCCPC, INC.	525 E Main St	WYTHEVILLE	VA	24382	(276) 228-4531	(828) 429-5988	fr960-CustSvc@orkin.com	Bill Campbell	M	FR960-Owner@orkin.com	bug.man09@yahoo.com	Northeast Division
961	D	A	GRINNING BULL LLC	609 S. Graham Street	STEPHENVILLE	TX	76401	(254) 965-4978	(254) 485-9263	fr961-CustSvc@orkin.com	Lisa Willett Walker	F	FR961-Owner@orkin.com	lwwalker@embarqmail.com	South Central Division
970	D	A	RAM QUALITY SERVICES III, LLC	12649 State Hwy 30	COLLEGE STATION	TX	77845	(907) 874-0660	(806) 584-5588	fr970-CustSvc@orkin.com	Merritt Vaughn	M	FR970-Owner@orkin.com	Hallemayr100@gmail.com	South Central Division
974	D	A	T & R ENTERPRISES OF OHIO, LLC	971 Linden Ave	ZANESVILLE	OH	43701	(740) 452-6300	(740) 221-5177	fr974-CustSvc@orkin.com	Chuck Self	M	FR974-Owner@orkin.com	orkin974@columbus.rr.com	Midwest Division
977	D	A	HILGER ENTERPRISES, INC.	3131-A W Venture Blvd.	BLOOMINGTON	IN	47404-3567	(812) 331-8066	(812) 369-1877	fr977-CustSvc@orkin.com	Betty Jo & Eugene Hilger	F	FR977-Owner@orkin.com	orkin977@comcast.net	Midwest Division
986	D	A	GOODROW ENTERPRISES, LLC	701 GA HWY 133 South	MOULTRIE	GA	31768	(229) 217-4887	(251) 298-7506	fr986-CustSvc@orkin.com	Keith Gaudreault	M	FR986-Owner@orkin.com	keith@orkinnow.com	Southeast Division
987	D	A	TSALD2, LLC	2521 Petty Drive	BOWLING GREEN	KY	42103	(270) 842-2428	(314) 346-0303	fr987-CustSvc@orkin.com	Terry Woods	M	FR987-Owner@orkin.com	TerryWoods@OrkinToday.com	Midwest Division
991	D	A	RAM QUALITY SERVICES, LLC	6007 43rd Street, Ste D	LUBBOCK	TX	79407	(806) 793-2232	(806) 584-5588	fr991-CustSvc@orkin.com	Merritt Vaughn	M	FR991-Owner@orkin.com	prvaughn@suddenlink.net	South Central Division

Midwest Division Organization Chart

August 2020

Change

8-5-20

DP		#339 MW Commercial	#389 Kentucky	#519 Illinois	#539 Iowa/Wisconsin	#559 Michigan	#579 Indiana/Ohio
Pat Chrzanowski							
ADP	RM	Steve Vey	Ken Harris	Don Fragakis	Rich Marlier	Glen Genther	Jason Shlater
Pat Murray							
DAA	ARM						
Lisa Williams	RSIsM	Brady Roenker	Mark Watkins	Cliff Brown	Rick Schoulte	Marty Cotter (RMT)	Brian Menke
Division Sales Mgr.	RSIsM						
Scott Weaver	ASIsM						
Div Tech Services Mgr.	RSvcM						
John Kane	RAA	Katie Fragakis	Teresa Mobley	Liz Buschmann	Donna Roe	Jewel Geist	Linda McDowell
Division HR Dir.	ABM						
Paige Wilder	BMT	Jennifer Pickens	Brad Trovillo	Brandon DeQuardo	Barry Oosterhouse		Rob Johnson
Division Recruiter	BMT	Ken Davidson	Chris Johns	James (Jim) Smith	Addam LeDoux	Brian Borders	
Karen Scheide %%%	BMT		Jeremy Young	Bryant Ruettiger		Clinton Baney	
Division Controller	BMT		Max Godby				
Bernice Austin	BMT						
Reg. Mgr. Trainee (RMT)	SMT	Chris Cook	John Backus	Roberto Blanco	Spencer Jones	James Bumgarner	Matt Witters
Akim Bamgbose	SMT	Richard Gruber	Chad Daniel	Lukas Genther	Adam Box	April McIntosh	Kevin Pribble
Reg. Mgr. Trainee (RMT)	SMT	Lindsay Borias	Jim Lanaghan	Craig Klimczak	Lindsey Gonsior	Shelby Rankin	Kevin Howard
David Bagley	SMT	Chris Donaldson	Tricia Banford	Roger Sadowski		Ross Volpe	Cody Dyke
	SMT	Doug Swift			Nathan Weilt		Stephen Ingram
	SMT						Brandon Oakley
	SMT						Charlie Smith
	SMT						
#615 Sales Center	Support Ctr			511 Illinois Support Ctr	603 Iowa/WI Support Ctr		
###				Josh Converse	Adam Schmidt (SM)		
%% Karen Scheide reports directly to Paige Wilder		387 NE Chicago OPEN	378 Lexington Rick Small	501 Elk Grove Bud Heavrin	524 Cedar Rapids Lane Cue	490 Parma Rodger Poindexter	504 Champaign Nick Fricano
### 615 Sales Ctr. reports directly to Scott Weaver		491 Cleveland Justin Whitmer	380 Louisville Brad Dunn	502 Aurora Dave Krugman	526 Davenport Addam LeDoux (BMT)	547 Pontiac Jason Sager	558 South Bend Michael Jacques
		546 St. Paul Andy Stockinger	484 Beckley Wm. Travis Hardin	508 Skokie Ninef Hermis	527 W Des Moines Corey Nelson	548 Mt. Clemens Derek Haberski	571 Ft. Wayne Steven Genther
		560 Columbus Bret Cremeans	486 Charleston Terry Lauchart	512 Joliet Bill Gambill	532 Omaha Roger Lisko	550 Traverse City Mike Pojeski	572 Indianapolis Randy Clarkson
		634 N Chicago Dave Tumminello	563 Florence Brad Trovillo (BMT)	513 Crystal Lake Tamara Tomic	536 Sioux City Gregory Cleveland	551 Lansing Mark Bennett	574 Kokomo Michael Brock
		666 Indianapolis Michael White	564 Cincinnati Jeremy Young (BMT)	514 Kankakee Riley Mallett	538 Waterloo Barry Oosterhouse (BMT)	553 Coldwater Scott Powers	576 Zionsville Micah Jewell
		670 Cincinnati Tara Leffel	568 Dayton Jeff Akins	516 LaSalle Tim Lewis	606 Dubuque Barry Oosterhouse (BMT)	554 Kalamazoo David Boer	577 Merrillville LaDaryl Lyte
		671 Chicago David Guyon	578 Portsmouth Matt Simon	518 Oak Park James Montalbano	608 Madison OPEN	555 Wayne Gary Lawson	580 Sidney Shawn Rust
		678 SW Chicago Amani Halim	583 Lebanon Gr. Tripp Ward	520 Alsip Brandon Trepina	609 Eau Claire Tim Kramer	556 Saginaw Bill Klingler	586 Bloomington Jeff Burkett
		690 Milwaukee Gary Dady	590 Evansville Eddie Beier	607 Fond du Lac Terri Micksch	611 LaCrosse Tim Kramer	557 Toledo Graig Wymer	589 Springfield Dale Alexander
		693 Detroit Bernie Thomas	592 Marion Chris Johns (BMT)	610 Milwaukee Brandon DeQuardo (BMT)	614 Rockford James Byrnes	562 Akron Jay Fusco	594 Peoria Jeff Burkett
				612 Green Bay Terri Micksch	617 Minneapolis Richard Hodgson	565 N Olmsted Bryan Shamhart	596 Terre Haute John Byerly
				618 Waukegan Greg Olzewski	784 Grand Island Brian Prokop	566 Columbus Scott Nowell	
				506 MG Waukesha Brandon DeQuardo (BMT)	790 Lincoln Brian Prokop	569 Grand Rapids Mike Pojeski	

085 Northeast Division - Organization Chart

Updated
8/10/20

Division President Art C. Watson		Asst. Division President Terry Groft	Division Sales Manager Tim Brady	Division Tech Services Dir. Open	Division Admin. Assistant Brittany Brown	Division Controller Kevin McDonald	Division Trainer Open	Div. Entomologist Open
		DHRM Karen Bradford	Division Recruiter Open					
53090 PermaTreat		279 NY Metro	329 Pennsylvania	369 New England	379 NY Upstate	449 Virginia	499 Beltway Commercial	509 Maryland
RM	Nick Castaldo	Joseph Garland	Ken Robertson	Open	Michael Hughes	Cory Smith	John Sutton	Shane Smith
ARM								
RSM	Troy Wolfrey	Michael Shaneman	Norman Haskins	John Tessier	Shawn Paylor	Gary Scott	Mike Finkel	Bill Whitcomb
ASM					Gil Squiers			
RMT								
RSVC								
RAA	Pat Abbott	Teresa Ching	Michele Dindak	Jill White	Diana Isgro	Lindsey Dye	Danielle Romasko	Patricia Markham
BMT		David Tonkovich	Holly Shipley	Carl Francis		Alex Bailey		
BMT				Dan Kiley		Joshua Asaro		
Special	Jack Broome							
	53000 Fredericksburg OPEN - Troy Wolfrey RSM	308 Philadelphia Lance Brooks BMT	300 Kirchner Brothers Jim Fish	700 Boston Commercial Bill Siegel	702 Utica Keith Getter	320 Fredericksburg Stephen Jones	343 Northern VA Tessa Wuchenich BMT	303 Rockville Joe Laraia
	53030 Culpeper OPEN - Tracy Wolfrey SM	311 Northern NJ Kenneth Murphy	302 Annandale Andrew Gabeau BMT	900 Portland Admin. Center OPEN	866 Hudson Valley Christopher Zeni BMT	440 Harrisonburg Robert Russell BMT	345 NJ Commercial Ryan Murphy BMT	305 North Baltimore Keith Livesay BMT
	53040 Woodbridge OPEN - Jason Frazier SM	313 Elmsford Anyelica Almonte BMT	306 Ashburn Hahmeed Darham BMT	910 N. Boston Brendan Gamache BMT	909 N. Hudson Valley Gil Squiers RMT	444 Hampton Chase Brown BMT	351 Washington Metro Blake Hunter	307 Baltimore Rob Ashworth
	53050 Charlottesville OPEN - Nick Castaldo RM	315 NYC Commercial Frederick Grimaldi	316 York Winston Sweeney	969 Bangor OPEN	964 Buffalo Paul Faubert BMT	451 Bon Air Jeffrey Barry	391 WI Baltimore John Olson	310 Salisbury David Clark BMT
	53060 Richmond Chris Barker	317 New Hyde Park Robert Kern BMT	480 N. Pittsburgh Willie Tisdale	980 Boston Admin. Center Bill Siegel	992 Queensbury Damian Marcello	453 VA Beach Jonathan Richards	601 DC Commerical OPEN	312 DC Clyde Neal
		318 Southern NJ Tracey Harper	481 S. Pittsburgh Jeff Brown	984 Monroe Rick Carey BMT	994 Albany Gil Squiers RMT	454 Richmond Bradley Ray	691 PennJersey Commercial Wayne Dove	314 Wilmington Clayton Rorie
		335 Central NJ Anthony Ciampi BMT	488 Clarksburg David Woodford	985 S. Boston Bill Siegel	995 Rochester Jason Coleman	456 Roanoke OPEN	694 Baltimore Commercial Robert Beery BMT	321 Carroll County Timothy Robertson
			647 Pittsburgh Commercial Bryan Ritzert	989 Portland OPEN	997 Syracuse Jeffrey Lidster BMT	457 Chesapeake Matt Ferrell BMT		323 Waldorf James Washington
				990 Pittsfield Dan Farrington BMT		648 Tidewater Commercial Jeff Banton		331 Lorton Stephen Garvey
				993 Hartford Jesse Parker BMT		660 Central VA Commercial Gary Compton BMT		447 Manassas Danielle Restuccia
				996 Burlington Michael Pierce		445 HomePro Zachary Scott BMT		540 Bel Air Celeste Curlee BMT
				998 Manchester Bill Siegel				
				855 Mainely Ticks Beth Falkner BMT				

Pacific Division - Organizational Chart

Updated
8/7/20

Division President Sean Murray	Asst Division President Mark Wyan	Division Sales Manager Kory Horlacher	Division Service Manager Open	Division Admin Assistant Tran Ly	DSAM Vincent Nguyen	Div. Entomologist Open
--	---	---	---	--	-------------------------------	----------------------------------

DHRD Elvia Fernandez	Division Recruiter Tamara Kaufman	Facilities Secretary Meagan Wright	Facilities Kevin Page	529 Canine Svcs Kristy Gardiner	733 Outbound Sales Open	
--------------------------------	---	--	---------------------------------	---	-----------------------------------	--

	711 Pacific Commercial	729 Northern California	749 Pacific Northwest	759 Southern Cal	789 Central California	829 Colorado	889 Southwest
RM	Bill Giorgi	JR Pasion	Darren Brisson	Ed Bove	Louis Warman	Machelle Stockstad	Erik Durrant
ARM	Miguel Diaz			Mike McKenzie		Brandon Blankenship	
RSLS		Saleem Taheri	Mark McConnell		Chris Anderson	Bobby Chauvin	Dawn Aguayo
RSVC	Robert / Derrick	Faizal Hussin		Ron Evans	Marcus Offutt (sls&svc)		
RAA	Charlene Schramm/Ann Harris	Randee Worster	Dean Russell	Yvonne Diaz	Roslynn Sevilla	Kallista Grimaldo	Liz Latimer
BMT	Gary Katz	Jennifer Neishi	Travis Paxson	Ron Riedell	Chris Sullivan	Greg Cornett	Shannon Free
BMT	Howard Grashin	Dawn Randazzo	Lance Freeman	William Peeveyhouse	Eddie Ramirez	Chris Reinhardt	

291 Comm Support	712 Nor Cal Support	763 NW Support	295 S Cal Support	294 Central Support	891 Colorado Support	837 SW Support
Cheryl Cano	Stephanie Wever	Douglas Comeau	Brandy McQuay	Amada Placencia	Denise Petch	Andrea Edgars
604 W. LA Comm	401 Stockton		487 EcoShield OC	157 Ventura	812 Fort Collins	735 Reno
Roy Gonzalez	Gulpid Singh		David Grant	Branden Mudd	Chad Wheeler	Nadine Mirabal
687 LA Comm	421 San Francisco	662 Seattle Comm	497 Palm Springs	706 Palmdale	825 Silverthorne	750 Las Vegas Res
Nadia Flores	Jesse Ballard	Steve Pelletier	Javier Jaramillo	Mike Silva	Stacy Drummey	Mike Giese
710 San Dimas Comm	437 North San Jose	704 Portland Comm	723 Vista	707 StoPest	883 Aurora	770 El Paso
Journett Pandey	Chris Shattuck -BMT	Curtis Green	Kevin Tinsley	Daniel Schwee	Joe Evans	Fidel Rodriguez
713 S LA Comm	438 Livermore	755 Spokane	724 Costa Mesa	722 Bakersfield	884 Durango	881 Mesa
Vinny Scardigno	Carlos Castellon -BMT	Tony Wilmes	Bill Toves	Daniel Schwee	Open	David Huihui
714 Riverside Comm	450 Silicon Valley Comm	756 Surety Pest	743 Long Beach	741 Fresno	888 Colorado Springs	882 Scottsdale
Michael Edwards	Juan Higueros	Chris Gomes	Aaron Laney	Jason Williamson	David Giacalone	Jim Krueger
715 San Fernando Comm	605 San Francisco Com	757 Eugene	746 N Orange County	748 Glendale	890 Denver	885 Las VEGS Comm
Tony Morales	Rafael Cabrera -BMT	Tony Braden	Josh Faur	Daniel Montes	Robert Esparza	Brian Zeck
717 Orange County C	661 Sacramento Comm	758 Everett	754 Pomona	761 Chatsworth	892 Grand Junction	886 Albuquerque
Jeff Mossinger	Charles Melvin	Bernie Von Herbulis	Mark Sonders	Benjamin Johns	Kai Kauai	Jim Flint
718 San Diego Comm	664 Livermore Comm	760 Portland	806 Orange County TC	767 Covina	893 Great Falls	894 Phoenix Comm
Gordon Nasser	Sean Archuleta	Steve Tracy	Russel Hufsey	Brian Bergeron	Tom McElroy	Ryan Bredek
751 Big Island	736 N. Cal SSG	762 Tacoma	821 Long Beach TC	783 Visalia	897 Denver Comm	896 Phoenix Res
Jed Horn	Steve Taylor	Mike Forrest	Darius Williams	Jonathan Bailey-BMT	Jennifer Smith	Justin Harris
800 Bird & Wildlife	737 N San Francisco	895 Salt Lake City	827 San Diego	811 W LA Res	370650 Crane	
Journett Pandey	Ronald Espiritu-BMT	Josh Bingham	Randy Jackson	Andy Hall	Donald Morris	
801 Honolulu	740 Oakland		4501 Hydrex	834 W LA TC		
Joe Lopiano	Rene Salinas		Brad Craig	Brian Bergeron		
797 SE Vertical sls	744 Hayward					
708 Metro Vertical sls	April Chamberlain					
716 West Vertical sls	745 San Jose					
	Leif Macaraeg					
	753 Sacramento					
	Dimitri Chavis					
	842 Bay Termite					
	Shelysee Patolo-BMT					
	795 North Vertical sls					



Orkin Region Managers

Aug-20

Midwest Division	Weaver	Scott	(248) 705-4805	sweaver@Rollins.com
Illinois Region	Brown	Cliff	(708) 355-1145	cbrown7@orkin.com
Indiana Ohio Region	Menke	Brian	(574) 847-1768	BMENKE@rollins.com
Iowa Wisconsin Region	Schoulte	Rick	(319) 558-8372	RSchoulte@rollins.com
Kentucky Region	Watkins	Mark	(859) 629-2164	mwatkins2@Rollins.com
Michigan Region	Cotter	Marty	(309) 530-1598	mcotter@orkin.com
Midwest Commercial Region	Roenker	Brady	(614) 356-0359	rroenker@rollins.com
Northeast Division	Brady	Tim	(301) 979-1178	tbrady@rollins.com
Maryland Region	Whitcomb	Bill	(401) 931-7281	wwhitcom@rollins.com
Virginia Region	Scott	Gary	(304) 419-3878	gscott@rollins.com
PermaTreat	Wolfrey	Troy	(540) 424-6077	TWolfrey@rollins.com
Pennsylvania Region	Harris	John	(484) 424-0184	jharris3@orkin.com
Pennsylvania Region	Haskins	Erik	(703) 656-6305	nhaskins@rollins.com
Metro NY Region	Shaneman	Mike	(680) 219-1346	mshanema@rollins.com
Upstate NY Region	Paylor	Shawn	(585) 358-1833	spaylor@orkin.com
New England Region	Tessier	John	(540) 290-5431	jtessier@orkin.com
Beltway Region	Finkel	Mike	(571) 319-7843	mfinkel@orkin.com
South Central Division	Rollins	Richard	(678) 431-8833	rrollins3@rollins.com
Gulf States Region	Spedale	Don	(225) 341-6981	dspedale@Rollins.com
South West Texas	James	Brent	(512) 920-6495	bjames1@Rollins.com
Kansas Missouri Region	Teal	Boe	(479) 225-2583	oteal@rollins.com
North Texas Oklahoma Region	Open			
South Central Commercial Region	Caples	Patricia	(504) 275-7078	pcaples@Rollins.com
Tennessee Region	Hutchinson	David	(865) 588-3400	dhutchinson@rollins.com
Southeast Division	Open			
South Florida Region	Vani	Marcello	(954) 882-7555	mvani@rollins.com
West Florida Region	Dougherty	Darren	(813) 888-6857	ddoughe1@orkin.com
North Florida Region	Holsapple	Phil	(786) 294-1889	pholsapple@orkin.com
Georgia Region	Watts	Tim	(770) 519-4285	twatts@orkin.com
North Carolina	Donnelly	Matt	(919) 604-1115	mtonnelly@rollins.com
South Carolina Region	Burros	Debra	(843) 593-3704	dburros@orkin.com
South Carolina Region	McCauley	Greg	(865) 399-9687	gmccaule@rollins.com
Southeast Commercial Region	Open			
Pacific Division	Horlacher	Kory	(951) 552-0725	khorlach@rollins.com
Southern California Region	McKenzie	Mike	(951) 710-0113	mmckenzie@rollins.com
Northern California Region	Taheri	Saleem	(925) 237-0995	staheri@orkin.com
Pacific Commercial Region	Kennedy	Derrick	(818) 581-7444	DKennedy@rollins.com
Central California Region	Anderson	Chris	(951) 278-6474	canders3@rollins.com
Pacific Commercial Region	Barr	Robert	(213) 261-7002	RBarr@rollins.com
Southwest Region	Wiersma	Dawn	(623) 692-5081	dwiersema@orkin.com
Northwest Region	McConnell	Mark	(916) 662-0585	mmcconne@rollins.com
Colorado Region	Chauvin	Bobby	(720) 636-8299	rchauvi1@orkin.com

2020 Org Chart - SOUTH CENTRAL DIVISION - LELAND MORRIS, PRESIDENT

Prepared 8/28/2020 11:51 AM

	President Leland Morris 4/18	Asst Div President James Earl Thomas 7/15	Div Sales Manager Richard Rollins 6/19	Div Service Manager Jim Ansley 1/20	DSAM Elaine Cole 1/01	Division Controller Michael Bryant 11/19
	DAA Scott Curtis 6/20				DHRM Shari Jones 11/17	Division Recruiter Kevin Brennan 3/20
	Gulf States 189 Gordon Melerine 9/18 Don Spedale 8/18 Cindy Thurman 12/12 Darrin Sherman/ Adam Webb Rudy Olivia Alexandria 174 \$2.1M Brenton Trahan (BMT) Quincy Lewis (SMT) Covington 175 \$2.3M Richard Kelly 8/19 Robert White Lake Charles 180 \$1.7M Jason Evans 9/15 Derek Felice (SMT) Monroe 182 \$2.2M Mike Mcdermott Robbie Accardo Natchitoches 184 \$1.3M Dale Diller BM/SM Shreveport 188 \$2.5M Chris Lawrence James Wheeler (SMT) Leland 204 \$1.1M Murray Strickland 12/99 None Gulfport 206 \$3.0M Josh Cox Russell Callen Jackson 210 \$3.2M Brant Covey BMT Gina Kilgore Baton Rouge 280 \$4.7M Frank Caluda (BMT) 3/20 C. Langois / N. Pearson Lafayette 288 \$3.6M Blake Borel 1/16/20 (BMT) Kevin Kidder(SMT) / Tony Joseph Houma 286 \$2.2M Jessica Guimbello 1/19 (BMT) Joe Allen Brent (SMT) New Orleans 292 \$6.2M Jamie Gilbert 8/19 John Carter (SMT)) Ben Eddingfield (SMT) Chris Ford (SMT)	Tennessee/Alabama 409 Gary Hubbard 4/18 David Hutchinson 7/18 Kendell Harmon 1/20 Ashley Helton 4/18 Brad Cernota Birmingham 106 \$3.3M Walter Wagers 4/20 Shawn Russell Huntsville 112 \$2.5M Phil Jordan (BMT) 4/20 Brad Hill/Russ Brooks (ABM) Montgomery 118 \$2.2M Jason Davis 9/18 Eric Willis Southaven 212 \$2.2M Jesse Clemente 2/19 Will Cayce Tupelo 216 \$2.0M Ryan Lovvorn (BMT) 5/20 Travis Evans Bristol 352 \$3.0M Michael Caldwell (6/20) Gary Coffey Cookeville 356 \$2.4M Shane Messer (BMT) 6/19 Ethan Prather Knoxville 360 \$4.7M Sam Burke (6/20) Mike Thress / Kevin Puvils Maryville 362 \$3.4M John Hines (BMT) 7/20 Kevin Kagley (SMT) Chattanooga - 420 \$2.9M Jeff Pursley 10/12 Mike Sarr Madison 431 \$2.4M Dustin Rush (BMT) Nathan Hastings (SMT) Memphis 433 \$2.7M Greg Sayger (BMT) 7/20 W. Tillman (SMT) Murfreesboro 434 \$2.1M Caleb Isenberg 1/20 Charles Hirsbrunner Nashville 436 \$3.3M Bruce Goodman 5/15 Braulio Estrada (SMT)	Kansas/MO 819 Ridge Warfield 9/18 Kendell Harmon 8/20 Chrissy Dantforth 2/05 Shauna Bailey / Michael Murdock Jerod Greenlee / Ryan Sigris Ft. Smith 726 \$1.6M Doug Stavig 12/18 Little Rock 732 \$2.0M Darius Taylor 10/19 (BMT) OPEN Kansas City 788 \$2.1M Will Jones 5/20 Shauna Bailey (BMT) Salina 792 \$1.5M Eric Jantz 10/10 Stephen Jackson Independence 793 \$3.2M Troy Johnson 5/20 Michael Brown / Jessie Jones Topeka 796 \$1.1M Will Jones 1/12 Shauan Bailey (BMT) Wichita 798 \$2.5M Mike Lynch 5/19 Austin Rosson Collinsville 813 \$2.5M Angie Boehne 10/19 BMT James Benwell Springfield 816 \$2.9M Joe Klafehn 8/19 Travis Toelke St. Louis South 817 \$3.8M Boe Teal 7/20 Charles Jordan Home Team St. Louis 870 \$1.7M Tony Jones 7/20 Tony Huckaba	N. Texas/Oklahoma 849 Alan Fowler 7/18 Kerry Maples-Batterman 8/18 Mona Crouch 7/91 Salisbury, Quinalty Ellert, Espinosa Parker Pest Control 738 \$1.7M Jeff Salisbury (BMT) 5/19 Open Ft. Worth PC 775 \$2.7M John Nash 9/14 Juan Albelo-Cajagas (SMT) Dallas/Ft. Worth TC 820 \$5.0M Solid Punches 12/11 Andre Sutton / Larry Burrell Midwest Pest - 823 \$2.8M Dallas Quinalty (BMT) 11/17 Chris Dobyms (SMT) Amarillo 824 \$1.8M Janice Abbasi 11/13 OPEN Dallas PC 826 \$3.9M Darrell Smith 6/17 Mike Myers Garland PC 830 \$1.7M Ron Walter 6/17 Open North Dallas PC 833 \$2.3M Kirk Webb - 8/19 Derek Stewart Tyler 836 \$2.8M Chris Landry 1/19 B. Tierney SMT/M. Anderson SMT Lawton 850 \$1.9M Tom Vickers 7/19 OPEN Oklahoma City 856 \$3.3M Bill Kennedy 1/19 Greg Rightler/Whitney Glover Tulsa 858 \$5.3M Chris Gibson 12/16 Jody Brown / Darrall Murdock A+ Pest Control 871 \$3.7M Robert (Kelly) Johnson 1/20 J. Wise (SMT)/C. Crosby(SMT)	South/West Texas 879 Brian Ramay 7/19 Brent James 7/19 Debbie Benavidez 7/16 Steven Garza John Culkin Sure Pest Control 738 \$2.3M Robert Serros 4/20 Xavier Southern(SMT) Killeen 772 \$2.7M Pennye Salazar 8/19 OPEN San Antonio 776 & SPC \$4.5M Shawn Stiles 8/19 Daniel Meyer / Craig Vannes Midland/Odessa 777 \$3.1M Chad Harmonson 1/19 Open Waco 778 \$2.4M Mike Kelly 10/95 Brian Martin Austin 780 \$5.2M Michael Wilburn Harry Cavazos - SVC Jimmy Brown Abilene 822 \$1.7M Michael Martinez 10/14 Burt Wolf (SMT) Beaumont 868 \$1.8M Eric Westmoreland 5/20 Todd Pressley Victoria 873 \$1.4M Colby Shodrock (SMT) Hunter Ansley Harlingen 874 \$3.1M Sergio Hernandez 1/04 Jesse Hernandez Metro Houston 876 \$3.0M Ed Lanigan 1/20 Jason St. Julian N. Houston 877 \$3.3M Chuck Hanson 1/19 Miquel Mercano S. Houston 878 \$3.6M John Coulter 2/20 Jason St. Julian	Commercial 899 Michael White 4/19 Trish Caples 1/20 Kristen Geddie 7/16 H. Holmes, Adam Dingwell M. Battey OK City Comm #205 \$1.9M Hayden Holmes 1/19 (BMT) Todd Gentry Knoxville Comm 358 \$2.2M Sante Harrah 7/17 Lance Helton Nashville Comm 427 \$2.3 Terry Castro 1/15 Open San Antonio Comm - 672 \$2.7M Joe Charles 1/09 Brian Howard St. Louis Comm - 677 \$3.1M Travis Kemper 3/05 Mike Wobbe Ft. Worth Com & YPC-680 \$4.1M Kim Dew 1/16/20 Jonathan Koehl (SMT) Dallas Comm - 684 \$5.5M Bryan Etheridge 6/19 Gareth Evans S. Houston Comm - 686 \$3.6M Glenn Bjornaas 6/18 James Hart SMT 10/19 New Orleans Comm - 695 \$3.7M Matthew Battey (BMT) 5/20 Bob Satterlee (SMT) Kansas City Comm - 791 \$2.7M Tim Henderson 2/19 Michael Pine Central Dallas Comm 828 \$2.1M Adam Dingwell 5/20 (BMT) Danny Jaso (SMT) N. Houston Comm 875 \$3.2M Cornelius Watson 7/18 Ernest Butler 10/19
RM RSLS RSVC RAA BMT BMT BM SVC	13 Branches Revenue \$36.1 Million	14 Branches Revenue \$39.1 Million	11 Branches Revenue \$24.9 Million	13 Branches Revenue \$40.7 Million	13 Branches Revenue \$38.1 Million	12 Branches Revenue \$37.1 Million

Southeast Division Organization Chart

Southeast Division Organization Chart								Aug. 2020
DP Phil Harris		NO. FLORIDA # 149	GEORGIA # 169	SO. FLORIDA # 199	NO. CAROLINA # 349	WEST FLORIDA # 399	SO. CAROLINA # 429	SO. COMMERCIAL # 659
ADP Barry Noll	RM	David Bridge	Mike Martin	JR Rodriguez	Ralph D'Ambrosio	JR Rodriguez	James Billingsley	Greg Saladino
DAA Stephanie Clarke	ARM			Marcello Vani		Darren Dougherty		
Division Sales Mgr. Tim Zimmerman	RSM	Phillip Holsapple	Earnest (Tim) Watts		Matthew Donnelly		Greg McCauley	OPEN
	RAA	Melissa Carlisle	Tracy Ralich	Carmen Mateo	Kathy Averette	Johanna Rios	Margaret Willis	Lavedra Guthrie-Hicks
Division Service Mgr. OPEN	NCS	Maggie Thomas	Chase Foster					
Division HR Mgr. Kevin Whitehead	BMT	Greg Terry		Erminio Fiore	Fred Nelson	Paul Johnson	Don Wallace	
	BMT				Jim Montgomery			
Division Recruiter Miller McGowan	BMT				Thomas Barrow			
	BMT							
Division Controller Kevin Griffin	SMT	Jessica Griffis						
	SMT							
		Cocoa # 132 Steve Friedmann	Conyers # 151 Adam Peterson	N. Miami # 191 OPEN	Durham # 322 William Lamarche	Brandon #128 Beau Bloem	Summerville # 209 Don Wallace (BMT)	Palm Beach # 655 Manny Noval
		Orlando PC # 134 Joe Franceschino	Chamblee # 152 Brandon Newton	Homestead # 192 Allan Cespedes	Fayetteville # 326 James Lee	Tampa # 130 Dave Bernstein	Augusta # 242 Thomas Laster	Charlotte Comm. # 665 Michael Martin
		Kissimmee # 146 Norbert Savard	Fayetteville # 158 Greg Peters	Key West # 194 Richard Mitchell, Jr.	New Bern # 334 Robert Martin	Hudson # 131 James Fletcher-Major	Savannah # 254 Andy Meola	Miami # 673 Rafael Valle
		Ocala # 224 Ryan Gard	Gainesville # 160 Jason Cleghorn	Miami # 196 Frank Padron	So. Raleigh # 336 Thomas Barrow (BMT)	St. Petersburg # 142 Mike Mccall	Asheville # 350 Bradley Eades	Roswell # 676 Matt Peterson
		Daytona # 226 Christopher Greif	Marietta # 164 Chris Nethercott	So. Broward # 197 Leandro Barbosa	Wilmington # 342 Fred Nelson (BMT)	Sarasota # 144 Andrew Bryan	Anderson # 392 Brandon Lewis	Atlanta # 681 Mike Palermo
		Panama City # 230 David Murphy	Lawrenceville # 165 Darrell Woodring	West Broward # 201 Javier Moya	Wilson # 344 David Haddix	Winter Haven # 148 John Lewis	Charleston # 396 Doug Bazzell	Raleigh Comm. # 683 Brian Rooney
		Pensacola # 232 Charles Swenson	Newnan # 166 William 'Travis' Brown	Delray Beach # 268 David Fountain	Rock Hill # 410 Charlie Bianco	Ft. Myers # 272 Kyle Thompson	Columbia # 398 Brian Alexander	Ft. Lauderdale # 685 Glen Chitty
		S. Jacksonville # 234 Keith Davis	Alpharetta # 168 Mike Brewer	Ft. Pierce # 274 Howard Jacobson	No. Charlotte # 462 Fred Wheeler	Naples # 275 Tom West	Florence # 402 Debra Burros	Tampa # 688 Brian Brockman
		Altamonte Springs # 235 Jeff Cutshall	Buckhead # 200 Rodney Hairston	No. Broward # 276 Wills Jarrett	So. Charlotte # 464 Jim Montgomery (BMT)		Greenville # 404 RJ Herber	Orlando # 696 Dan Stockslager
		Brunswick # 258 Jessica Griffis (SMT)	Holly Springs # 202 Ryan McClendon	West Palm Beach # 278 Chad Brockway	No. Raleigh #467 Andy Bartholomew		Hilton Head #405 Chris Watring	
		N. Jacksonville # 675 John Gay	Dublin # 250 Terry Beasley		Greensboro # 470 Brett McCracken		Myrtle Beach # 406 Barry Wyels	
			Macon # 252 Andy Kitchens		Hickory # 472 Brian Sheppard		Franklin # 475 Tim Davis	
					Winston-Salem # 478 Don Hauck			

FOR OFFICIAL USE ONLY / SOURCE SELECTION INFORMATION - SEE FAR 2.101, 3.104, AND 42.1503

CONTRACTOR PERFORMANCE ASSESSMENT REPORT (CPAR)**Nonsystems****Name/Address of Contractor:**

Company Name: ORKIN EXTERMINATING CO

Division Name:

Street Address: 2170 PIEDMONT RD NE

City: ATLANTA

State/Province: GA Zip Code: 303244135

Country: USA

CAGE Code:

DUNS Number: 002509420

PSC: S207 NAICS Code: 561710

Evaluation Type: Interim**Contract Percent Complete:****Period of Performance Being Assessed:** 02/21/2018 - 02/20/2019**Contract Number:** GS06F0003N 36C26018F1466 **Business Sector & Sub-Sector:** Nonsystems - Facilities Services**Contracting Office:** 260-NETWORK CONTRACT OFFIC20(00260) **Contracting Officer:** CRYSTAL PARRIS **Phone Number:** 253-888-4923**Location of Work:**

Seattle WA

Award Date: 02/21/2018 **Effective Date:** 02/21/2018**Completion Date:** 01/31/2023 **Estimated/Actual Completion Date:****Total Dollar Value:** \$545,250 **Current Contract Dollar Value:** \$109,050**Complexity:** Low **Termination Type:** None**Competition Type:** Full and Open Competition **Contract Type:** Firm Fixed Price**Key Subcontractors and Effort Performed:****DUNS:****Effort:****DUNS:****Effort:****DUNS:****Effort:****Project Number:****Project Title:**

Pest Control

Contract Effort Description:

pest control Puget sound washington

Small Business Subcontracting:

Does this contract include a subcontracting plan? No

Date of last Individual Subcontracting Report (ISR) / Summary Subcontracting Report (SSR): N/A

Evaluation Areas	Past Rating	Rating
Quality:	N/A	Very Good
Schedule:	N/A	Very Good
Cost Control:	N/A	Very Good
Management:	N/A	Very Good
Small Business Subcontracting:	N/A	Very Good
Regulatory Compliance:	N/A	Very Good
Other Areas:		
(1) :		N/A
(2) :		N/A
(3) :		N/A

FOR OFFICIAL USE ONLY

FOR OFFICIAL USE ONLY / SOURCE SELECTION INFORMATION - SEE FAR 2.101, 3.104, AND 42.1503

Variance (Contract to Date):

Current Cost Variance (%): Variance at Completion (%):

Current Schedule Variance (%):

Assessing Official Comments:

QUALITY: The Contracting Officer's point of contact reports that the contractor's quality has been very good.

SCHEDULE: The Contracting Officer's point of contact reports that the contractor's schedule compliance has been very good.

COST CONTROL: The Contracting Officer's point of contact reports that the contractor's cost control has been very good.

MANAGEMENT: The Contracting Officer's point of contact reports that the contractor's management has been very good.

SMALL BUSINESS SUBCONTRACTING: The Contracting Officer's point of contact reports that the contractor's small business compliance has been very good.

REGULATORY COMPLIANCE: The Contracting Officer's point of contact reports that the contractor's regulatory compliance has been very good.

ADDITIONAL/OTHER: The Contracting Officer's point of contact reports that the contractor's performance has been very good.

RECOMMENDATION:

Given what I know today about the contractor's ability to perform in accordance with this contract or order's most significant requirements, I would recommend them for similar requirements in the future.

Name and Title of Assessing Official:

Name: PEGGY BOWEN

Title: Division Chief

Organization: RPOW / NCO20

Phone Number: 208-429-2033 Email Address: peggy.bowen@va.gov

Date: 01/16/2020

Contractor Comments:

ADDITIONAL/OTHER: Orkin values our partnership with the VA Puget Sound Healthcare System. We continue to strive to provide quality, on-time services for the Veterans, their families and staff at the VA locations. Orkin will work to find efficiencies and effective control methods to improve on our performance.

CONCURRENCE: I concur with this evaluation.

Name and Title of Contractor Representative:

Name: Deborah A Toth

Title: Government Business Development Mgr

Phone Number: 770-220-6165 Email Address: dthoth@rollins.com

Date: 01/20/2020

Review by Reviewing Official:

Review by Reviewing Official not required.

Name and Title of Reviewing Official:

Name:

Title:

Organization:

Phone Number: Email Address:

Date:

FOR OFFICIAL USE ONLY

FOR OFFICIAL USE ONLY

Print

Close

FOR OFFICIAL USE ONLY / SOURCE SELECTION INFORMATION - SEE FAR 2.101, 3.104, AND 42.1503

CONTRACTOR PERFORMANCE ASSESSMENT REPORT (CPAR)**Nonsystems****Name/Address of Contractor:**

Company Name: ORKIN EXTERMINATING CO

Division Name:

Street Address: 2170 PIEDMONT RD NE

City: ATLANTA

State/Province: GA Zip Code: 303244135

Country: USA

CAGE Code:

DUNS Number: 002509420

PSC: S207 NAICS Code: 561710

Evaluation Type: Interim**Contract Percent Complete:****Period of Performance Being Assessed:** 02/01/2018 - 01/30/2019**Contract Number:** GS06F0003N VA25515F1511 **Business Sector & Sub-Sector:** Nonsystems - Facilities Services**Contracting Office:** 255-NETWORK CONTRACT OFC 15(00255) **Contracting Officer:** FRANK NOVELLO **Phone Number:** 913-946-1962**Location of Work:**

VA St. Louis Health Care System

Award Date: 01/30/2015 **Effective Date:** 02/01/2015**Completion Date:** 01/31/2020 **Estimated/Actual Completion Date:****Total Dollar Value:** \$273,864 **Current Contract Dollar Value:** \$273,864**Complexity:** Low **Termination Type:** None**Competition Type:** Full and Open Competition **Contract Type:** Firm Fixed Price**Key Subcontractors and Effort Performed:****DUNS:****Effort:****DUNS:****Effort:****DUNS:****Effort:****Project Number:****Project Title:**

Pest Control, VA St. Louis Health Care System

Contract Effort Description:

Furnish all labor, supervision, materials, and equipment necessary to accomplish the surveillance, trapping, pesticide applications, and pest removal components of the IPM Program. The Contractor shall provide detailed, site-specific recommendations for structural and procedural modifications to aid in pest prevention within the St. Louis VA Health Care system.

Small Business Subcontracting:

Does this contract include a subcontracting plan? No

Date of last Individual Subcontracting Report (ISR) / Summary Subcontracting Report (SSR): N/A

Evaluation Areas**Past Rating****Rating**

Quality:

Very Good

Very Good

Schedule:

Very Good

Very Good

Cost Control:

Satisfactory

Satisfactory

Management:

Satisfactory

Very Good

Small Business Subcontracting:

N/A

N/A

Regulatory Compliance:

Satisfactory

Satisfactory

Other Areas:

FOR OFFICIAL USE ONLY / SOURCE SELECTION INFORMATION - SEE FAR 2.101, 3.104, AND 42.1503
FOR OFFICIAL USE ONLY

(1): N/A
(2): N/A
(3): N/A

Variance (Contract to Date):

Current Cost Variance (%): Variance at Completion (%):

Current Schedule Variance (%):

Assessing Official Comments:

QUALITY: The Contractor's performance during the period of performance as exceed the contract.

SCHEDULE: Provide constant communication in regards to scheduling services. All service are performed in accordance with the contract as required.

COST CONTROL: N/A

MANAGEMENT: Management team member are always available and very professional. The management team responds to all inquires in a timely manner and address all concerns prior to becoming issues.

REGULATORY COMPLIANCE: The contractor provided all services in accordance with all federal, state and local laws and regulations.

ADDITIONAL/OTHER: Given what I know today about the contractor's ability to perform in accordance with this contract's or order's most significant requirements, I would defiantly award future contracts to this vendor.

RECOMMENDATION:

Given what I know today about the contractor's ability to perform in accordance with this contract or order's most significant requirements, I would recommend them for similar requirements in the future.

Name and Title of Assessing Official:

Name: FRANK NOVELLO

Title: Contracting Officer

Organization: Department of Veterans Affairs

Phone Number: 913-946-1962 Email Address: frank.novello@va.gov

Date: 04/22/2019

Contractor Comments:

ADDITIONAL/OTHER: The Orkin Service Team takes great pride in working for the veterans, their families and the staff at the VA. Orkin will continue to strive for efficiencies and improved performance for the St. Louis VA HealthCare System.

CONCURRENCE: I concur with this evaluation.

Name and Title of Contractor Representative:

Name: DEBORAH TOTH

Title: GSA/Government Contract Manager

Phone Number: 770-220-6165 Email Address: dtoth@rollins.com

Date: 04/24/2019

Review by Reviewing Official:

Review by Reviewing Official not required.

Name and Title of Reviewing Official:

Name:

Title:

Organization:

Phone Number: Email Address:

Date:

FOR OFFICIAL USE ONLY / SOURCE SELECTION INFORMATION - SEE FAR 2.101, 3.104, AND 42.1503
FOR OFFICIAL USE ONLY

Print Close

FOR OFFICIAL USE ONLY / SOURCE SELECTION INFORMATION - SEE FAR 2.101, 3.104, AND 42.1503

CONTRACTOR PERFORMANCE ASSESSMENT REPORT (CPAR)**Nonsystems****Name/Address of Contractor:**

Company Name: ORKIN EXTERMINATING CO

Division Name:

Street Address: 2170 PIEDMONT RD NE

City: ATLANTA

State/Province: GA Zip Code: 303244135

Country: USA

CAGE Code:

DUNS Number: 002509420

PSC: S207 NAICS Code: 561710

Evaluation Type: Final**Contract Percent Complete:****Period of Performance Being Assessed:** 04/01/2018 - 12/31/2019**Contract Number:** GS06F0003N VA25514F2736 **Business Sector & Sub-Sector:** Nonsystems - Facilities Services**Contracting Office:** 255-NETWORK CONTRACT OFC 15(00255) **Contracting Officer:** FRANK NOVELLO **Phone Number:** 913-946-1962**Location of Work:****Award Date:** 04/01/2014 **Effective Date:** 04/01/2014**Completion Date:** 09/30/2019 **Estimated/Actual Completion Date:** 12/31/2019**Total Dollar Value:** \$184,878 **Current Contract Dollar Value:** \$184,878**Complexity:** Low **Termination Type:** None**Competition Type:** Full and Open Competition **Contract Type:** Firm Fixed Price**Key Subcontractors and Effort Performed:****DUNS:****Effort:****DUNS:****Effort:****DUNS:****Effort:****Project Number:****Project Title:**

Pest Control Services at the Marion, IL, VA Medical Center

Contract Effort Description:

PESTS INCLUDED: The contractor shall meet the performance expectations of the client in Suppressing/eliminating the following pests:

- 1) General structural arthropod pests (i.e., cockroaches, ants, carpet beetles, spiders, carpenter ants, carpenter bees, etc.) including drains. Termites and other wood destroying organisms are not included and services are available on a per instance basis for an additional cost.
- 2) Flying insect pests (i.e., houseflies, stable flies, blowflies, etc.)
- 3) Parasitic pests (i.e., lice, bedbugs, fleas, mites, ticks, mosquitoes, etc.)
- 4) Invader pests (i.e., bees, wasps, scorpions, pill bugs, crickets, saw tooth grain beetles, red/confused flour beetles, grain moths, etc.)
- 5) Mice and rats (i.e. house mice, field mice, roof rats, Norway rats etc.)
- 6) Pest birds (i.e., pigeons, sparrows, blackbirds, etc.)
- 7) Other vertebrate pests (i.e., dogs, cats, bats, squirrels, gophers, groundhogs, moles, skunks, snakes, rabbits, etc.) Wildlife is not included but available on a per occurrence basis.
- 8) Lawn and turf pests (i.e., sod webworm, cinch bugs, crickets, Japanese beetle larvae, armyworms, cutworms, wireworms, ants, wasps, crabgrass, chickweed, broadleaf weeds, molds, blights, rusts, anthracnose, mildews, fungi, etc.) Services do not include Lawn and Ornamental, Tree pests, bacteria or fungi.
- 9) Shade tree and ornamental pests (i.e., aphids, scales, meal bugs, mites, weevils, leaf miners, caterpillars, borers, sawflies, chaffers, bacterial diseases, fungi, etc.)
- 10) Wood destroying organisms (i.e., subterranean termites, dry wood termites, fungi wood boring beetles, etc.) This service is not included however it is available for an additional charge.
- 11) Aquatic pests (i.e., mosquito larvae/pupae, algae, etc.)

Small Business Subcontracting:

FOR OFFICIAL USE ONLY

FOR OFFICIAL USE ONLY / SOURCE SELECTION INFORMATION - SEE FAR 2.101, 3.104, AND 42.1503

Does this contract include a subcontracting plan? No

Date of last Individual Subcontracting Report (ISR) / Summary Subcontracting Report (SSR): N/A

Evaluation Areas	Past Rating	Rating
Quality:	Very Good	Satisfactory
Schedule:	Satisfactory	Satisfactory
Cost Control:	N/A	N/A
Management:	Very Good	Very Good
Small Business Subcontracting:	N/A	N/A
Regulatory Compliance:	Satisfactory	Satisfactory
Other Areas:		
(1) :		N/A
(2) :		N/A
(3) :		N/A

Variance (Contract to Date):

Current Cost Variance (%): Variance at Completion (%):

Current Schedule Variance (%):

Assessing Official Comments:

QUALITY: The Contractor's performance was rated with Satisfactory, but there were not any comments provided. This Past Performance Assessment has been given a satisfactory rating for this performance period.

SCHEDULE: The Contractor's performance was rated with Satisfactory, but there were not any comments provided. This Past Performance Assessment has been given a satisfactory rating for this performance period.

MANAGEMENT: Managers of the contract company are very knowledgeable, billing and invoices are correct and timely. Invoices are submitted electronically as per contract; all issues and concerns are addressed in a timely manner.

REGULATORY COMPLIANCE: The contractor provided all services in accordance with all federal, state and local laws and regulations.

ADDITIONAL/OTHER: Given what I know today about the contractor's ability to perform in accordance with this contract or order's most significant requirements, I would recommend them for similar requirements in the future.

RECOMMENDATION:

Given what I know today about the contractor's ability to perform in accordance with this contract or order's most significant requirements, I would recommend them for similar requirements in the future.

Name and Title of Assessing Official:

Name: FRANK NOVELLO

Title: Contracting Officer

Organization: Department of Veterans Affairs

Phone Number: 913-946-1962 Email Address: frank.novello@va.gov

Date: 01/14/2020

Contractor Comments:

ADDITIONAL/OTHER: Orkin continues to strive to improve our service and administrative performance for the VA Marion. We value our partnerships with the VA and consider it a privilege to provide services for our veterans, their families and the staff at the VA Marion.

We are duty bound to do our best and be our best for the VA.

CONCURRENCE: I concur with this evaluation.

Name and Title of Contractor Representative:

Name: Deborah A Toth

Title: Government Contract Manager

Phone Number: 770-220-6165 Email Address: dthoth@rollins.com

FOR OFFICIAL USE ONLY

FOR OFFICIAL USE ONLY / SOURCE SELECTION INFORMATION - SEE FAR 2.101, 3.104, AND 42.1503

Date: 01/15/2020

Review by Reviewing Official:

Review by Reviewing Official not required.

Name and Title of Reviewing Official:

Name:

Title:

Organization:

Phone Number: Email Address:

Date:

FOR OFFICIAL USE ONLY

Due to the competitive landscape of the industry, pricing and the answers submitted as part of e-bid system are available upon request.